

SOLID CARBIDE BLOCK PUNCHES

- STANDARD, RECTANGLE (CBAC)
- STANDARD, RECTANGLE WITH TiCN COATING (TBAC)

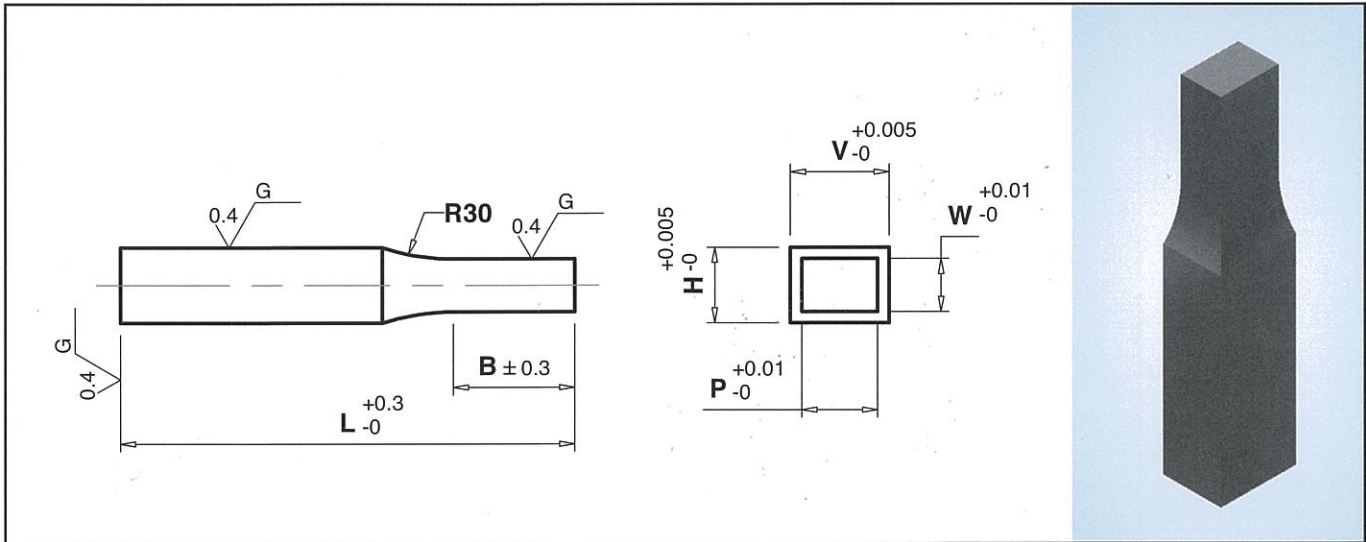

Shank Size		P Point Size		B Point Length	L - Length				
H	V	P	W		40	50	60	70	80
1.500 – 3.990	1.500 – 3.990	1.500 – 2.990	1.500 – 2.990	8 – 13	•	•	•		
2.000 – 4.990	2.000 – 4.990	1.500 – 3.990	1.500 – 3.990	8 – 13	•	•	•	•	
2.000 – 5.990	2.000 – 5.990	1.500 – 4.990	1.500 – 4.990	8 – 13	•	•	•	•	
3.000 – 7.990	3.000 – 7.990	2.000 – 5.990	2.000 – 5.990	13 – 19	•	•	•	•	•
3.000 – 9.990	3.000 – 9.990	3.000 – 7.990	3.000 – 7.990	13 – 19	•	•	•	•	•
6.000 – 12.990	6.000 – 12.990	3.000 – 9.990	3.000 – 9.990	13 – 19	•	•	•	•	•
10.000 – 15.990	10.000 – 15.990	6.000 – 12.990	6.000 – 12.990	19 – 25	•	•	•	•	•
13.000 – 19.990	13.000 – 19.990	10.000 – 15.990	10.000 – 15.990	19 – 25	•	•	•	•	•
18.000 – 24.990	18.000 – 24.990	13.000 – 19.990	13.000 – 19.990	19 – 25	•	•	•	•	•

Note: Other Dimension Not Listed above can be ground to your specifications.
 If in doubt please send us your drawing. 'D' tolerance is m5 or +0.005.
 Unless otherwise specified by customer all outside corners will be sharp.

How to order : **CBAC – H – V – P – W – B – L**

Example : **TBAC – H2.000 – V2.000 – P1.500 – W1.500 – B8 – L40**

SOLID CARBIDE BLOCK PUNCHES

- STANDARD, RECTANGLE WITH AIR HOLE (**CBAD**)
- STANDARD, RECTANGLE WITH AIR HOLE WITH TiCN COATING (**TBAD**)

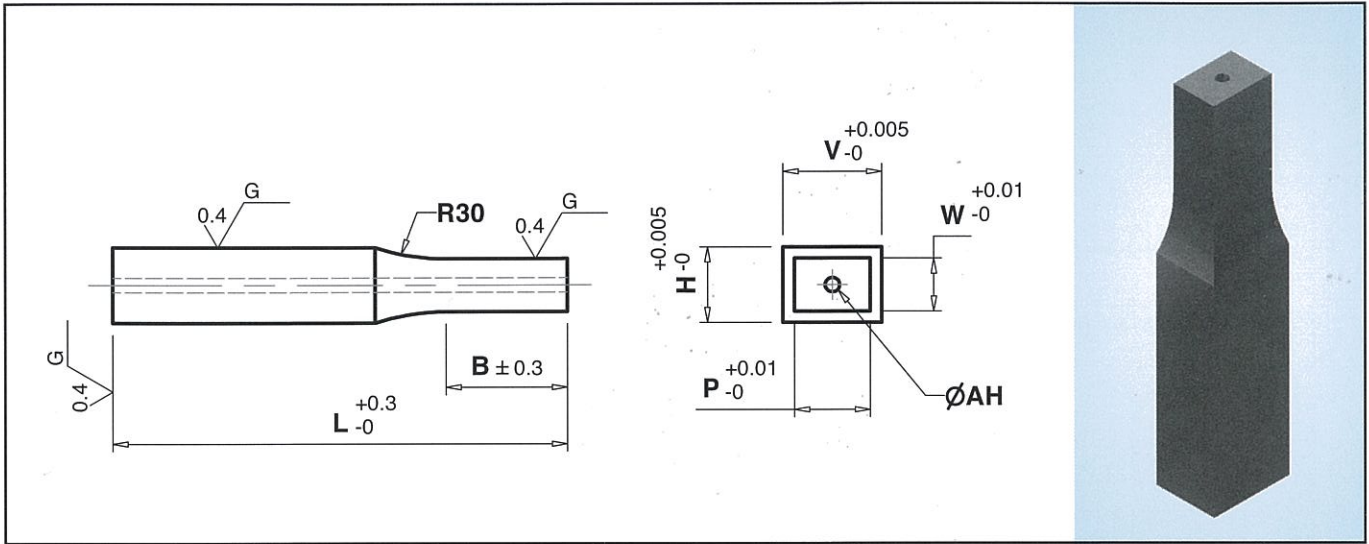

Shank Size		P Point Size		B Point Length	AH Air Hole	L – Length				
H	V	P	W			40	50	60	70	80
1.500 – 3.990	1.500 – 3.990	1.500 – 2.990	1.500 – 2.990	8 – 13	0.5	•	•	•		
2.000 – 4.990	2.000 – 4.990	1.500 – 3.990	1.500 – 3.990	8 – 13	0.8	•	•	•	•	
2.000 – 5.990	2.000 – 5.990	1.500 – 4.990	1.500 – 4.990	8 – 13	0.8	•	•	•	•	
3.000 – 7.990	3.000 – 7.990	2.000 – 5.990	2.000 – 5.990	13 – 19	1.2	•	•	•	•	•
3.000 – 9.990	3.000 – 9.990	3.000 – 7.990	3.000 – 7.990	13 – 19	1.6	•	•	•	•	•
6.000 – 12.990	6.000 – 12.990	3.000 – 9.990	3.000 – 9.990	13 – 19	1.9	•	•	•	•	•
10.000 – 15.990	10.000 – 15.990	6.000 – 12.990	6.000 – 12.990	19 – 25	2.9	•	•	•	•	•
13.000 – 19.990	13.000 – 19.990	10.000 – 15.990	10.000 – 15.990	19 – 25	2.9	•	•	•	•	•
18.000 – 24.990	18.000 – 24.990	13.000 – 19.990	13.000 – 19.990	19 – 25	2.9	•	•	•	•	•

Note: Other Dimension Not Listed above can be ground to your specifications.
 If in doubt please send us your drawing. 'D' tolerance is m5 or +0.005.
 Unless otherwise specified by customer all outside corners will be sharp.

How to order : **CBAD – H – V – P – W – B – L**
 Example : **TBAD – H2.000 – V2.000 – P1.500 – W1.500 – B8 – L40**

SOLID CARBIDE BLOCK PUNCHES

- STANDARD, OBLONG (CBAE)
- STANDARD, OBLONG WITH TiCN COATING (TBAE)

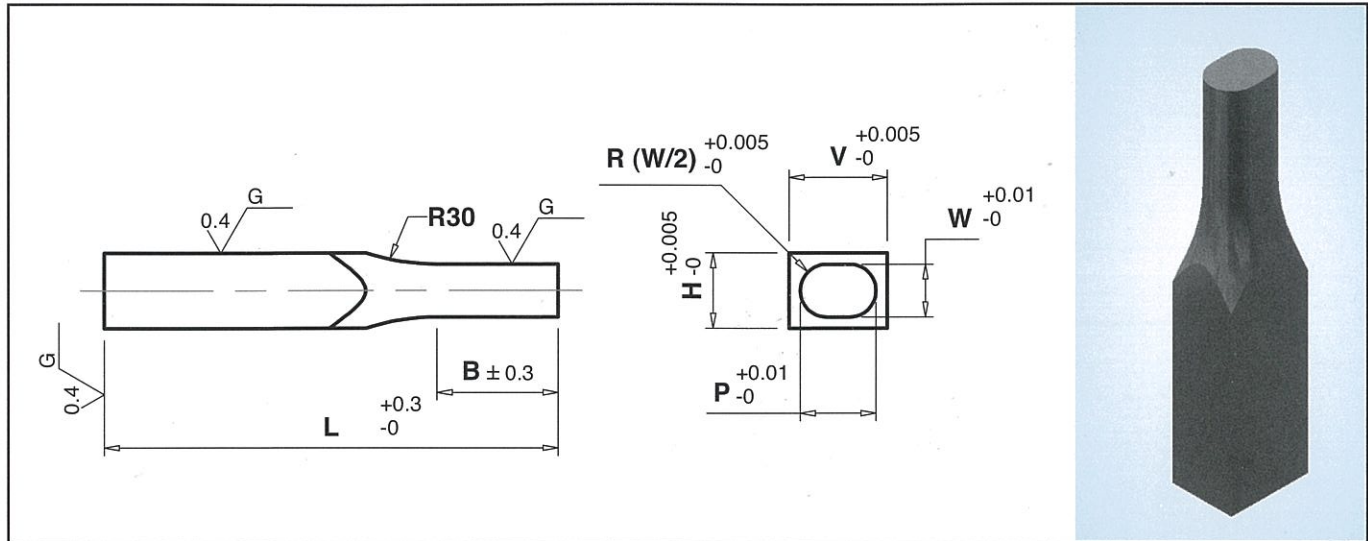

Shank Size		P Point Size		B Point Length	L – Length				
H	V	P	W		40	50	60	70	80
1.500 – 3.990	1.500 – 3.990	1.500 – 2.990	1.500 – 2.990	8 – 13	•	•	•		
2.000 – 4.990	2.000 – 4.990	1.500 – 3.990	1.500 – 3.990	8 – 13	•	•	•	•	
2.000 – 5.990	2.000 – 5.990	1.500 – 4.990	1.500 – 4.990	8 – 13	•	•	•	•	
3.000 – 7.990	3.000 – 7.990	2.000 – 5.990	2.000 – 5.990	13 – 19	•	•	•	•	•
3.000 – 9.990	3.000 – 9.990	3.000 – 7.990	3.000 – 7.990	13 – 19	•	•	•	•	•
6.000 – 12.990	6.000 – 12.990	3.000 – 9.990	3.000 – 9.990	13 – 19	•	•	•	•	•
10.000 – 15.990	10.000 – 15.990	6.000 – 12.990	6.000 – 12.990	19 – 25	•	•	•	•	•
13.000 – 19.990	13.000 – 19.990	10.000 – 15.990	10.000 – 15.990	19 – 25	•	•	•	•	•
18.000 – 24.990	18.000 – 24.990	13.000 – 19.990	13.000 – 19.990	19 – 25	•	•	•	•	•

Note: Other Dimension Not Listed above can be ground to your specifications.
 If in doubt please send us your drawing. 'D' tolerance is m5 or +0.005.
 Unless otherwise specified by customer all outside corners will be sharp.

How to order : CBAE – H – V – P – W – B – L

Example : TBAE – H2.000 – V2.000 – P1.500 – W1.500 – B8 – L40

SOLID CARBIDE BLOCK PUNCHES



- OBLONG WITH AIR HOLE (CBAF)
- OBLONG WITH AIR HOLE WITH TiCN COATING (TBAF)

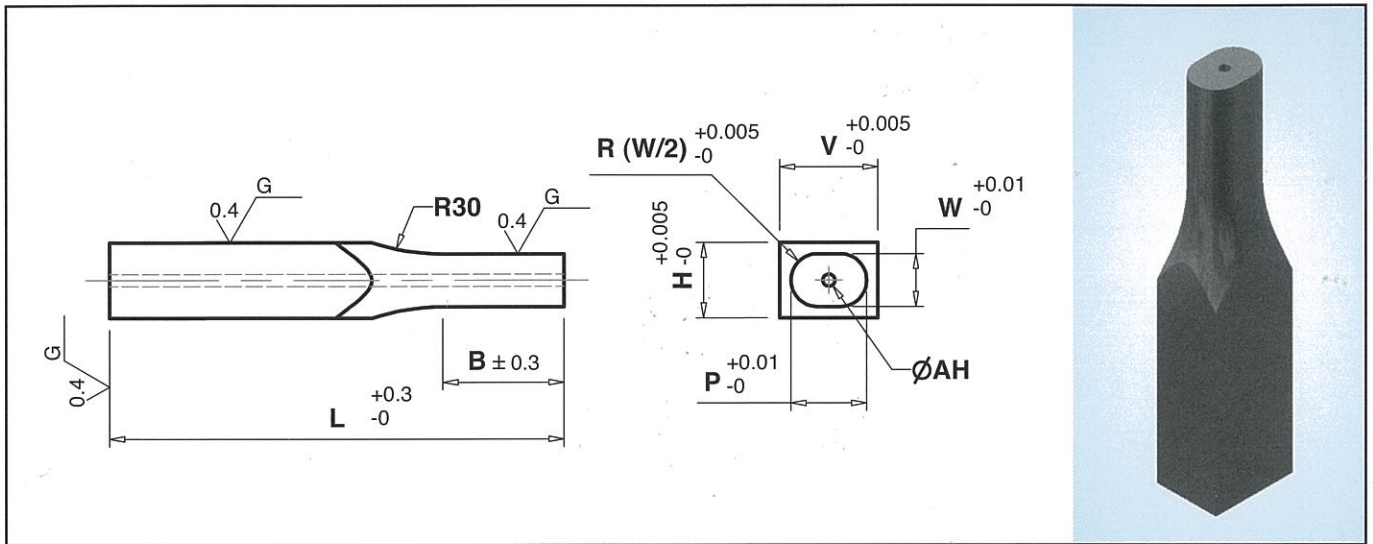

Shank Size		P Point Size		B Point Length	AH Air Hole	L – Length				
H	V	P	W							
1.500 – 3.990	1.500 – 3.990	1.500 – 2.990	1.500 – 2.990	8 – 13	0.5	40	50	60	70	80
2.000 – 4.990	2.000 – 4.990	1.500 – 3.990	1.500 – 3.990	8 – 13	0.8	•	•	•		
2.000 – 5.990	2.000 – 5.990	1.500 – 4.990	1.500 – 4.990	8 – 13	0.8	•	•	•	•	
3.000 – 7.990	3.000 – 7.990	2.000 – 5.990	2.000 – 5.990	13 – 19	1.2	•	•	•	•	
3.000 – 9.990	3.000 – 9.990	3.000 – 7.990	3.000 – 7.990	13 – 19	1.6	•	•	•	•	•
6.000 – 12.990	6.000 – 12.990	3.000 – 9.990	3.000 – 9.990	13 – 19	1.9	•	•	•	•	•
10.000 – 15.990	10.000 – 15.990	6.000 – 12.990	6.000 – 12.990	19 – 25	2.9	•	•	•	•	•
13.000 – 19.990	13.000 – 19.990	10.000 – 15.990	10.000 – 15.990	19 – 25	2.9	•	•	•	•	•
18.000 – 24.990	18.000 – 24.990	13.000 – 19.990	13.000 – 19.990	19 – 25	2.9	•	•	•	•	•

Note: Other Dimension Not Listed above can be ground to your specifications.
 If in doubt please send us your drawing. 'D' tolerance is m5 or +0.005.
 Unless otherwise specified by customer all outside corners will be sharp.

How to order : **CBAF – H – V – P – W – B – L**
 Example : **TBAF – H2.000 – V2.000 – P1.500 – W1.500 – B8 – L40**

SOLID CARBIDE BLOCK PUNCHES

- STANDARD, FLATTED ROUND (CBAG)
- STANDARD, FLATTED ROUND WITH TiCN COATING (TBAG)

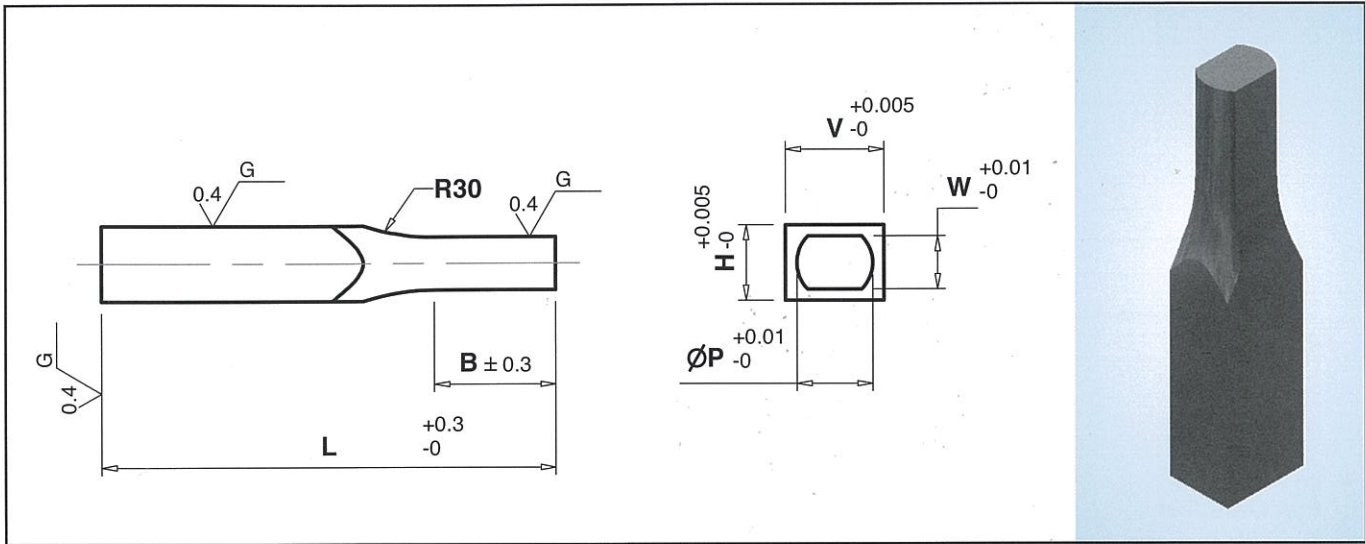

Shank Size		P Point Size		B Point Length	L – Length				
H	V	P	W		40	50	60	70	80
1.500 – 3.990	1.500 – 3.990	1.500 – 2.990	1.500 – 2.990	8 – 13	•	•	•		
2.000 – 4.990	2.000 – 4.990	1.500 – 3.990	1.500 – 3.990	8 – 13	•	•	•	•	
2.000 – 5.990	2.000 – 5.990	1.500 – 4.990	1.500 – 4.990	8 – 13	•	•	•	•	
3.000 – 7.990	3.000 – 7.990	2.000 – 5.990	2.000 – 5.990	13 – 19	•	•	•	•	•
3.000 – 9.990	3.000 – 9.990	3.000 – 7.990	3.000 – 7.990	13 – 19	•	•	•	•	•
6.000 – 12.990	6.000 – 12.990	3.000 – 9.990	3.000 – 9.990	13 – 19	•	•	•	•	•
10.000 – 15.990	10.000 – 15.990	6.000 – 12.990	6.000 – 12.990	19 – 25	•	•	•	•	•
13.000 – 19.990	13.000 – 19.990	10.000 – 15.990	10.000 – 15.990	19 – 25	•	•	•	•	•
18.000 – 24.990	18.000 – 24.990	13.000 – 19.990	13.000 – 19.990	19 – 25	•	•	•	•	•

Note: Other Dimension Not Listed above can be ground to your specifications.
 If in doubt please send us your drawing. 'D' tolerance is m5 or +0.005.
 Unless otherwise specified by customer all outside corners will be sharp.

How to order : **CBAG – H – V – P – W – B – L**

Example : **TBAG – H2.000 – V2.000 – P1.500 – W1.500 – B8 – L40**

SOLID CARBIDE BLOCK PUNCHES



- STANDARD, FLATTED ROUND WITH AIR HOLE (**CBAH**)
- STANDARD, FLATTED ROUND WITH AIR HOLE WITH TiCN COATING (**TBAH**)

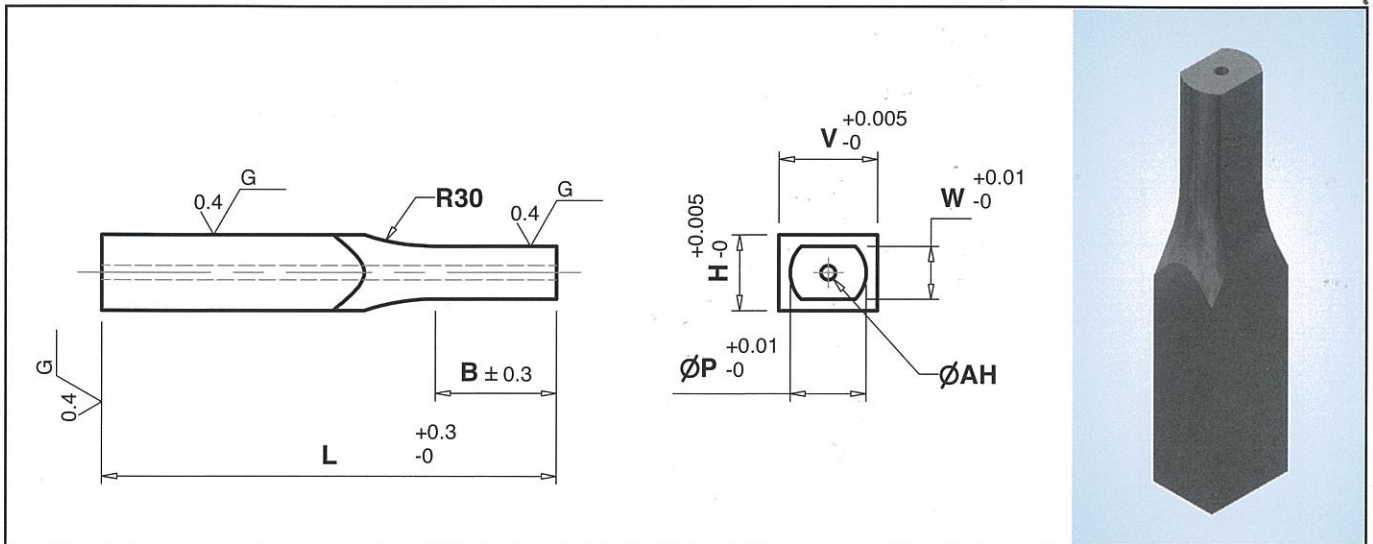

Shank Size		P Point Size		B Point Length	AH Air Hole	L – Length				
H	V	P	W							
1.500 – 3.990	1.500 – 3.990	1.500 – 2.990	1.500 – 2.990	8 – 13	0.5	40	50	60	70	80
2.000 – 4.990	2.000 – 4.990	1.500 – 3.990	1.500 – 3.990	8 – 13	0.8	•	•	•		
2.000 – 5.990	2.000 – 5.990	1.500 – 4.990	1.500 – 4.990	8 – 13	0.8	•	•	•	•	
3.000 – 7.990	3.000 – 7.990	2.000 – 5.990	2.000 – 5.990	13 – 19	1.2	•	•	•	•	
3.000 – 9.990	3.000 – 9.990	3.000 – 7.990	3.000 – 7.990	13 – 19	1.6	•	•	•	•	•
6.000 – 12.990	6.000 – 12.990	3.000 – 9.990	3.000 – 9.990	13 – 19	1.9	•	•	•	•	•
10.000 – 15.990	10.000 – 15.990	6.000 – 12.990	6.000 – 12.990	19 – 25	2.9	•	•	•	•	•
13.000 – 19.990	13.000 – 19.990	10.000 – 15.990	10.000 – 15.990	19 – 25	2.9	•	•	•	•	•
18.000 – 24.990	18.000 – 24.990	13.000 – 19.990	13.000 – 19.990	19 – 25	2.9	•	•	•	•	•

Note: Other Dimension Not Listed above can be ground to your specifications.
 If in doubt please send us your drawing. 'D' tolerance is m5 or +0.005.
 Unless otherwise specified by customer all outside corners will be sharp.

How to order : **CBAH – H – V – P – W – B – L**
 Example : **TBAH – H2.000 – V2.000 – P1.500 – W1.500 – B8 – L40**

SOLID CARBIDE BLOCK PUNCHES

- STANDARD, RECTANGLE w/ CORNER RADIUS (**CBAJ**)
- STANDARD, RECTANGLE w/ CORNER RADIUS WITH TiCN COATING (**TBAJ**)

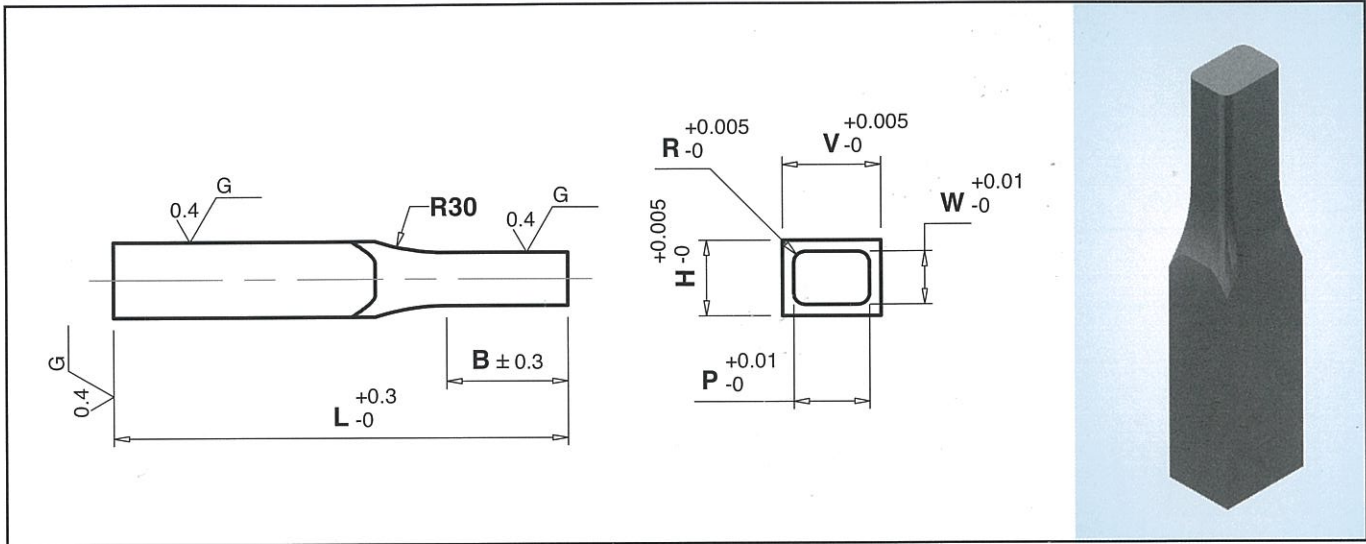

Shank Size		P Point Size		B Point Length	L – Length				
H	V	P	W		40	50	60	70	80
1.500 – 3.990	1.500 – 3.990	1.500 – 2.990	1.500 – 2.990	8 – 13	•	•	•		
2.000 – 4.990	2.000 – 4.990	1.500 – 3.990	1.500 – 3.990	8 – 13	•	•	•	•	
2.000 – 5.990	2.000 – 5.990	1.500 – 4.990	1.500 – 4.990	8 – 13	•	•	•	•	
3.000 – 7.990	3.000 – 7.990	2.000 – 5.990	2.000 – 5.990	13 – 19	•	•	•	•	•
3.000 – 9.990	3.000 – 9.990	3.000 – 7.990	3.000 – 7.990	13 – 19	•	•	•	•	•
6.000 – 12.990	6.000 – 12.990	3.000 – 9.990	3.000 – 9.990	13 – 19	•	•	•	•	•
10.000 – 15.990	10.000 – 15.990	6.000 – 12.990	6.000 – 12.990	19 – 25	•	•	•	•	•
13.000 – 19.990	13.000 – 19.990	10.000 – 15.990	10.000 – 15.990	19 – 25	•	•	•	•	•
18.000 – 24.990	18.000 – 24.990	13.000 – 19.990	13.000 – 19.990	19 – 25	•	•	•	•	•

Note: Other Dimension Not Listed above can be ground to your specifications.
 If in doubt please send us your drawing. 'D' tolerance is m5 or +0.005.
 Unless otherwise specified by customer all outside corners will be sharp.

How to order : **CBAJ – H – V – P – W – B – L – R**

Example : **TBAJ – H2.000 – V2.000 – P1.500 – W1.500 – B8 – L40 – R0.15**

SOLID CARBIDE BLOCK PUNCHES



- STANDARD, RECTANGLE w/ CORNER RADIUS WITH AIR HOLE (**CBAK**)
- STANDARD, RECTANGLE w/ CORNER RADIUS WITH AIR HOLE WITH TiCN COATING (**CBAK**)

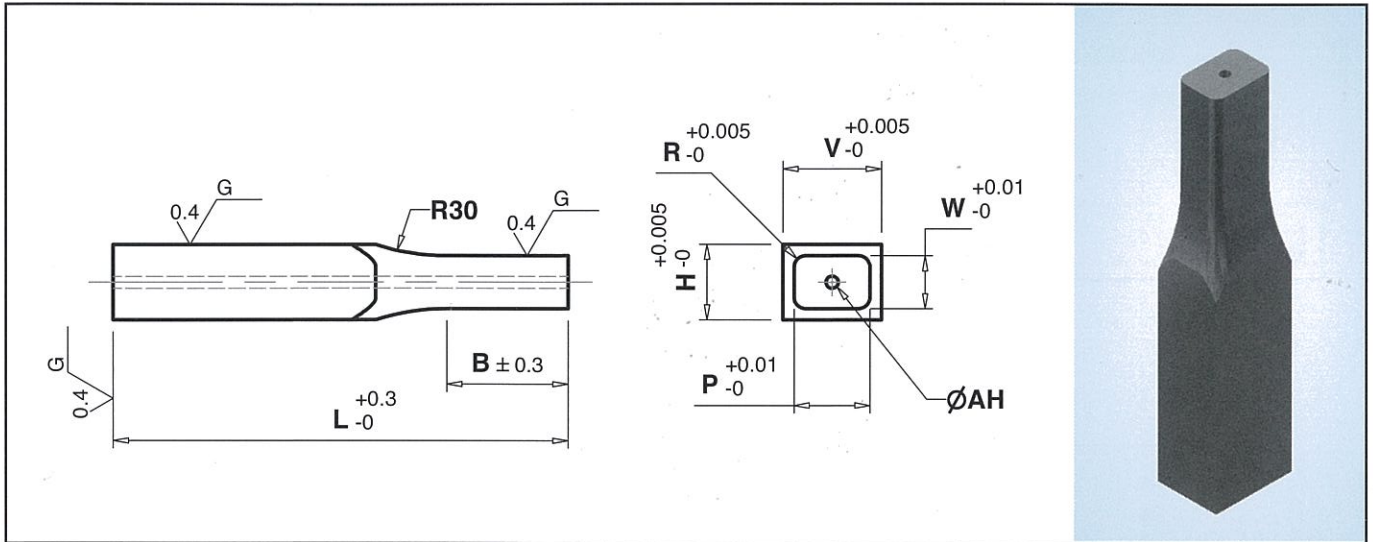

Shank Size		P Point Size		B Point Length	AH Air Hole	L – Length				
H	V	P	W			40	50	60	70	80
1.500 – 3.990	1.500 – 3.990	1.500 – 2.990	1.500 – 2.990	8 – 13	0.5	•	•	•		
2.000 – 4.990	2.000 – 4.990	1.500 – 3.990	1.500 – 3.990	8 – 13	0.8	•	•	•	•	
2.000 – 5.990	2.000 – 5.990	1.500 – 4.990	1.500 – 4.990	8 – 13	0.8	•	•	•	•	
3.000 – 7.990	3.000 – 7.990	2.000 – 5.990	2.000 – 5.990	13 – 19	1.2	•	•	•	•	•
3.000 – 9.990	3.000 – 9.990	3.000 – 7.990	3.000 – 7.990	13 – 19	1.6	•	•	•	•	•
6.000 – 12.990	6.000 – 12.990	3.000 – 9.990	3.000 – 9.990	13 – 19	1.9	•	•	•	•	•
10.000 – 15.990	10.000 – 15.990	6.000 – 12.990	6.000 – 12.990	19 – 25	2.9	•	•	•	•	•
13.000 – 19.990	13.000 – 19.990	10.000 – 15.990	10.000 – 15.990	19 – 25	2.9	•	•	•	•	•
18.000 – 24.990	18.000 – 24.990	13.000 – 19.990	13.000 – 19.990	19 – 25	2.9	•	•	•	•	•

Note: Other Dimension Not Listed above can be ground to your specifications.
 If in doubt please send us your drawing. 'D' tolerance is m5 or +0.005.
 Unless otherwise specified by customer all outside corners will be sharp.

How to order : **CBAK – H – V – P – W – B – L – R**
 Example : **TBAK – H2.000 – V2.000 – P1.500 – W1.500 – B8 – L40 – R0.15**

SOLID CARBIDE BLOCK PUNCHES



- TAPPED, RECTANGLE (CBBC)
- TAPPED, RECTANGLE WITH TiCN COATING (TBBC)

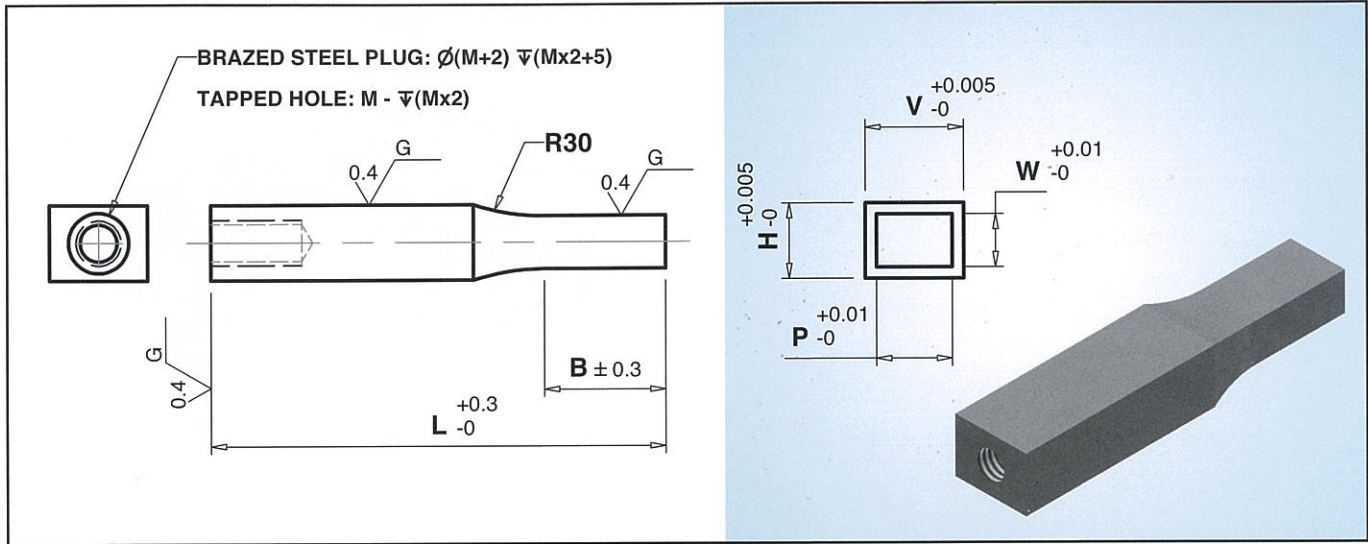

Shank Size		P Point Size		B Point Length	L – Length				
H	V	P	W		40	50	60	70	80
1.500 – 3.990	1.500 – 3.990	1.500 – 2.990	1.500 – 2.990	8 – 13	•	•	•		
2.000 – 4.990	2.000 – 4.990	1.500 – 3.990	1.500 – 3.990	8 – 13	•	•	•	•	
2.000 – 5.990	2.000 – 5.990	1.500 – 4.990	1.500 – 4.990	8 – 13	•	•	•	•	
3.000 – 7.990	3.000 – 7.990	2.000 – 5.990	2.000 – 5.990	13 – 19	•	•	•	•	•
3.000 – 9.990	3.000 – 9.990	3.000 – 7.990	3.000 – 7.990	13 – 19	•	•	•	•	•
6.000 – 12.990	6.000 – 12.990	3.000 – 9.990	3.000 – 9.990	13 – 19	•	•	•	•	•
10.000 – 15.990	10.000 – 15.990	6.000 – 12.990	6.000 – 12.990	19 – 25	•	•	•	•	•
13.000 – 19.990	13.000 – 19.990	10.000 – 15.990	10.000 – 15.990	19 – 25	•	•	•	•	•
18.000 – 24.990	18.000 – 24.990	13.000 – 19.990	13.000 – 19.990	19 – 25	•	•	•	•	•

Note: Other Dimension Not Listed above can be ground to your specifications.
 If in doubt please send us your drawing. 'D' tolerance is m5 or +0.005.
 Unless otherwise specified by customer all outside corners will be sharp.

How to order : **CBBC – H – V – P – W – B – L**

Example : **TBBC – H2.000 – V2.000 – P1.500 – W1.500 – B8 – L40**

SOLID CARBIDE BLOCK PUNCHES



- TAPPED, RECTANGLE WITH AIR HOLE (CBBB)
- TAPPED, RECTANGLE WITH AIR HOLE WITH TiCN COATING (TBBD)

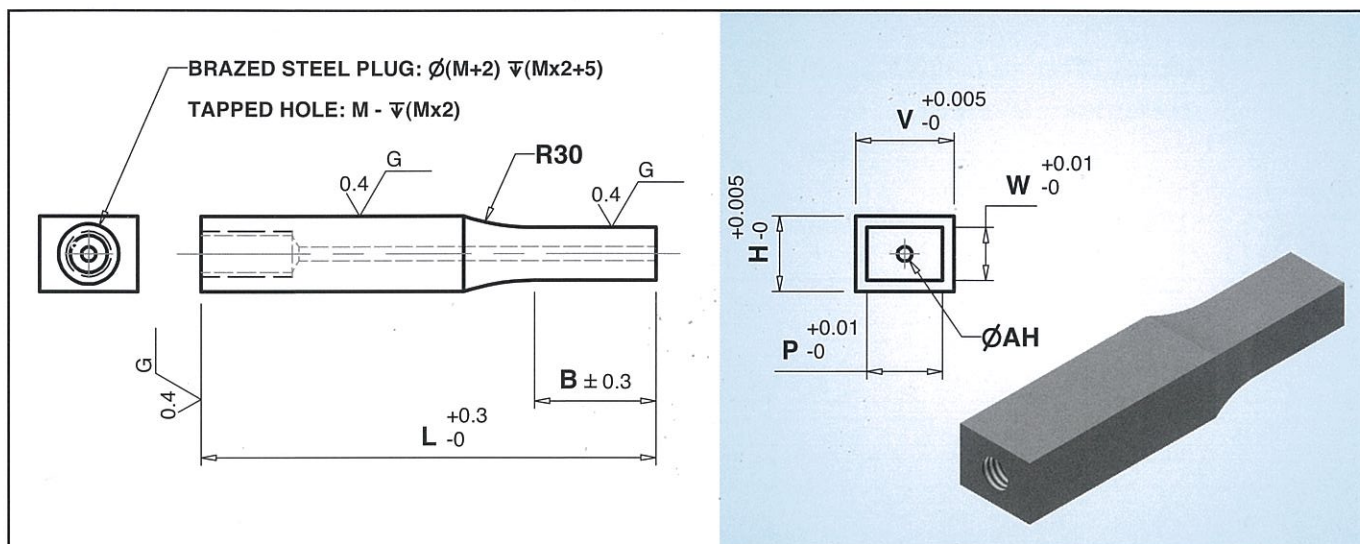

Shank Size		P Point Size		B Point Length	AH Air Hole	L – Length				
H	V	P	W			40	50	60	70	80
1.500 – 3.990	1.500 – 3.990	1.500 – 2.990	1.500 – 2.990	8 – 13	0.5	•	•	•		
2.000 – 4.990	2.000 – 4.990	1.500 – 3.990	1.500 – 3.990	8 – 13	0.8	•	•	•	•	
2.000 – 5.990	2.000 – 5.990	1.500 – 4.990	1.500 – 4.990	8 – 13	0.8	•	•	•	•	
3.000 – 7.990	3.000 – 7.990	2.000 – 5.990	2.000 – 5.990	13 – 19	1.2	•	•	•	•	•
3.000 – 9.990	3.000 – 9.990	3.000 – 7.990	3.000 – 7.990	13 – 19	1.6	•	•	•	•	•
6.000 – 12.990	6.000 – 12.990	3.000 – 9.990	3.000 – 9.990	13 – 19	1.9	•	•	•	•	•
10.000 – 15.990	10.000 – 15.990	6.000 – 12.990	6.000 – 12.990	19 – 25	2.9	•	•	•	•	•
13.000 – 19.990	13.000 – 19.990	10.000 – 15.990	10.000 – 15.990	19 – 25	2.9	•	•	•	•	•
18.000 – 24.990	18.000 – 24.990	13.000 – 19.990	13.000 – 19.990	19 – 25	2.9	•	•	•	•	•

Note: Other Dimension Not Listed above can be ground to your specifications.
 If in doubt please send us your drawing. 'D' tolerance is m5 or +0.005.
 Unless otherwise specified by customer all outside corners will be sharp.

How to order : **CBBB – H – V – P – W – B – L**

Example : **TBBD – H2.000 – V2.000 – P1.500 – W1.500 – B8 – L40**

SOLID CARBIDE BLOCK PUNCHES



- TAPPED, OBLONG (CBBE)
- TAPPED, OBLONG WITH TiCN COATING (TBBE)

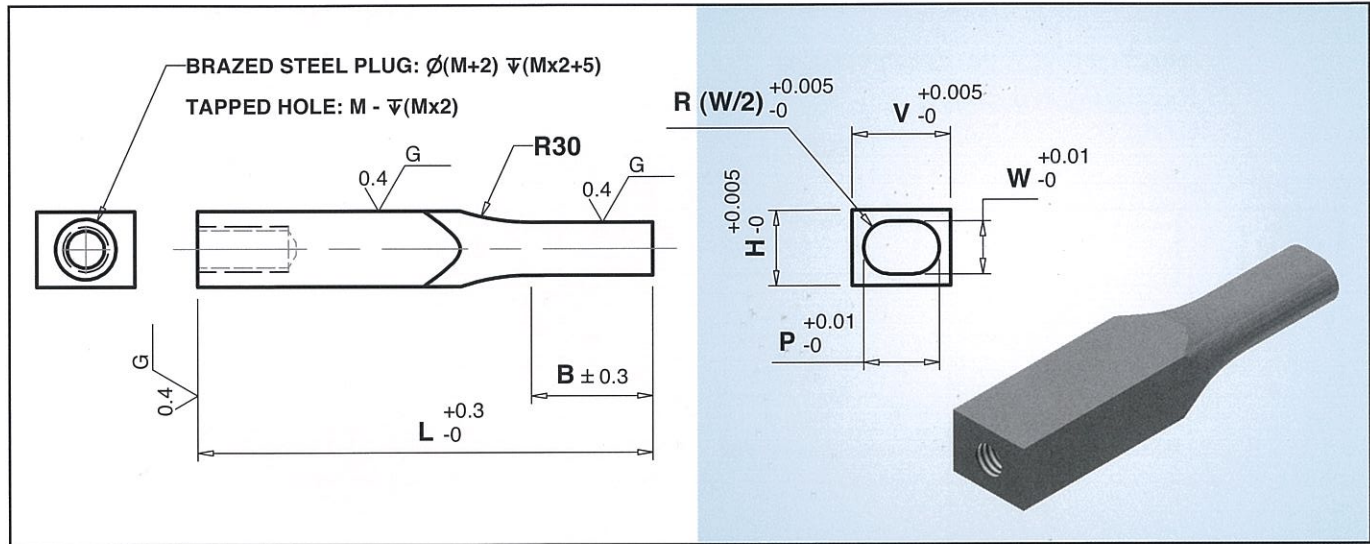

Shank Size		P Point Size		B Point Length	L – Length				
H	V	P	W		40	50	60	70	80
1.500 – 3.990	1.500 – 3.990	1.500 – 2.990	1.500 – 2.990	8 – 13	•	•	•		
2.000 – 4.990	2.000 – 4.990	1.500 – 3.990	1.500 – 3.990	8 – 13	•	•	•	•	
2.000 – 5.990	2.000 – 5.990	1.500 – 4.990	1.500 – 4.990	8 – 13	•	•	•	•	
3.000 – 7.990	3.000 – 7.990	2.000 – 5.990	2.000 – 5.990	13 – 19	•	•	•	•	•
3.000 – 9.990	3.000 – 9.990	3.000 – 7.990	3.000 – 7.990	13 – 19	•	•	•	•	•
6.000 – 12.990	6.000 – 12.990	3.000 – 9.990	3.000 – 9.990	13 – 19	•	•	•	•	•
10.000 – 15.990	10.000 – 15.990	6.000 – 12.990	6.000 – 12.990	19 – 25	•	•	•	•	•
13.000 – 19.990	13.000 – 19.990	10.000 – 15.990	10.000 – 15.990	19 – 25	•	•	•	•	•
18.000 – 24.990	18.000 – 24.990	13.000 – 19.990	13.000 – 19.990	19 – 25	•	•	•	•	•

Note: Other Dimension Not Listed above can be ground to your specifications.
 If in doubt please send us your drawing. 'D' tolerance is m5 or +0.005.
 Unless otherwise specified by customer all outside corners will be sharp.

How to order : **CBBE – H – V – P – W – B – L**

Example : **TBBE – H2.000 – V2.000 – P1.500 – W1.500 – B8 – L40**

SOLID CARBIDE BLOCK PUNCHES



- TAPPED, OBLONG WITH AIR HOLE (CBBF)
- TAPPED, OBLONG WITH AIR HOLE WITH TiCN COATING (TBBF)

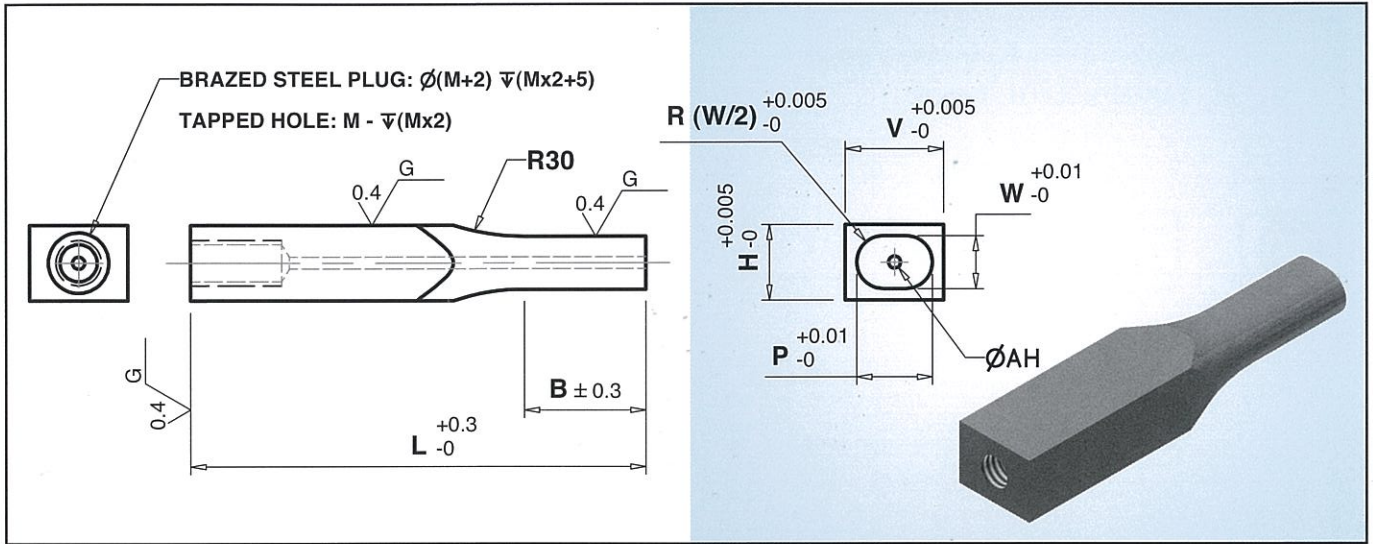

Shank Size		P Point Size		B Point Length	AH Air Hole	L – Length				
H	V	P	W			40	50	60	70	80
1.500 – 3.990	1.500 – 3.990	1.500 – 2.990	1.500 – 2.990	8 – 13	0.5	•	•	•		
2.000 – 4.990	2.000 – 4.990	1.500 – 3.990	1.500 – 3.990	8 – 13	0.8	•	•	•	•	
2.000 – 5.990	2.000 – 5.990	1.500 – 4.990	1.500 – 4.990	8 – 13	0.8	•	•	•	•	
3.000 – 7.990	3.000 – 7.990	2.000 – 5.990	2.000 – 5.990	13 – 19	1.2	•	•	•	•	•
3.000 – 9.990	3.000 – 9.990	3.000 – 7.990	3.000 – 7.990	13 – 19	1.6	•	•	•	•	•
6.000 – 12.990	6.000 – 12.990	3.000 – 9.990	3.000 – 9.990	13 – 19	1.9	•	•	•	•	•
10.000 – 15.990	10.000 – 15.990	6.000 – 12.990	6.000 – 12.990	19 – 25	2.9	•	•	•	•	•
13.000 – 19.990	13.000 – 19.990	10.000 – 15.990	10.000 – 15.990	19 – 25	2.9	•	•	•	•	•
18.000 – 24.990	18.000 – 24.990	13.000 – 19.990	13.000 – 19.990	19 – 25	2.9	•	•	•	•	•

Note: Other Dimension Not Listed above can be ground to your specifications.
 If in doubt please send us your drawing. 'D' tolerance is m5 or +0.005.
 Unless otherwise specified by customer all outside corners will be sharp.

How to order : **CBBF – H – V – P – W – B – L**
 Example : **TBBF – H2.000 – V2.000 – P1.500 – W1.500 – B8 – L40**

SOLID CARBIDE BLOCK PUNCHES



- TAPPED, FLATTED ROUND (CBBG)
- TAPPED, FLATTED ROUND WITH TiCN COATING (TBBG)

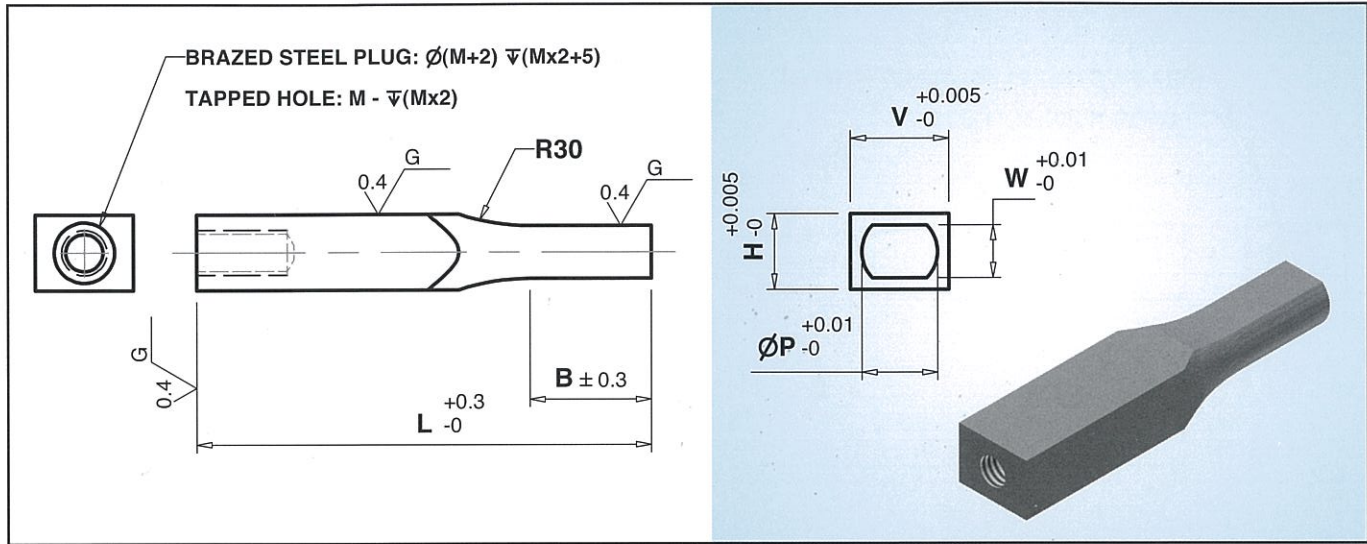

Shank Size		P Point Size		B Point Length	L – Length				
H	V	P	W		40	50	60	70	80
1.500 – 3.990	1.500 – 3.990	1.500 – 2.990	1.500 – 2.990	8 – 13	•	•	•		
2.000 – 4.990	2.000 – 4.990	1.500 – 3.990	1.500 – 3.990	8 – 13	•	•	•	•	
2.000 – 5.990	2.000 – 5.990	1.500 – 4.990	1.500 – 4.990	8 – 13	•	•	•	•	
3.000 – 7.990	3.000 – 7.990	2.000 – 5.990	2.000 – 5.990	13 – 19	•	•	•	•	•
3.000 – 9.990	3.000 – 9.990	3.000 – 7.990	3.000 – 7.990	13 – 19	•	•	•	•	•
6.000 – 12.990	6.000 – 12.990	3.000 – 9.990	3.000 – 9.990	13 – 19	•	•	•	•	•
10.000 – 15.990	10.000 – 15.990	6.000 – 12.990	6.000 – 12.990	19 – 25	•	•	•	•	•
13.000 – 19.990	13.000 – 19.990	10.000 – 15.990	10.000 – 15.990	19 – 25	•	•	•	•	•
18.000 – 24.990	18.000 – 24.990	13.000 – 19.990	13.000 – 19.990	19 – 25	•	•	•	•	•

Note: Other Dimension Not Listed above can be ground to your specifications.
 If in doubt please send us your drawing. 'D' tolerance is m5 or +0.005.
 Unless otherwise specified by customer all outside corners will be sharp.

How to order : **CBBG – H – V – P – W – B – L**

Example : **TBBG – H2.000 – V2.000 – P1.500 – W1.500 – B8 – L40**

SOLID CARBIDE BLOCK PUNCHES



- TAPPED, FLATTED ROUND WITH AIR HOLE (**CBBH**)
- TAPPED, FLATTED ROUND WITH AIR HOLE WITH TiCN COATING (**TBBH**)

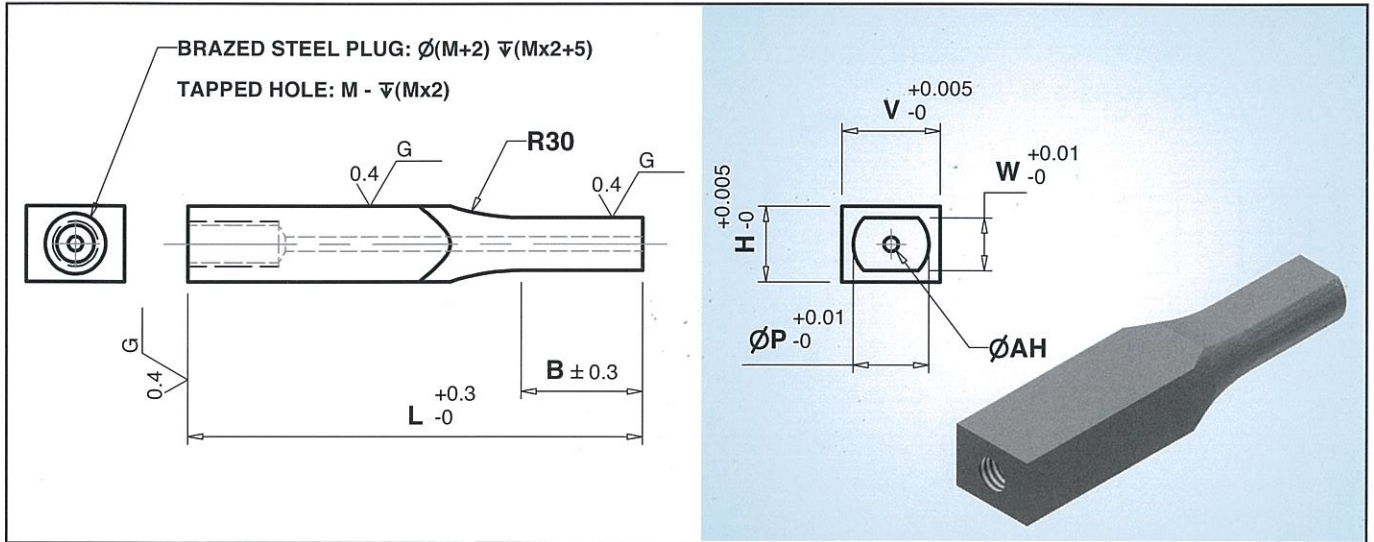

Shank Size		P Point Size		B Point Length	AH Air Hole	L - Length				
H	V	P	W			40	50	60	70	80
1.500 – 3.990	1.500 – 3.990	1.500 – 2.990	1.500 – 2.990	8 – 13	0.5	•	•	•		
2.000 – 4.990	2.000 – 4.990	1.500 – 3.990	1.500 – 3.990	8 – 13	0.8	•	•	•	•	
2.000 – 5.990	2.000 – 5.990	1.500 – 4.990	1.500 – 4.990	8 – 13	0.8	•	•	•	•	
3.000 – 7.990	3.000 – 7.990	2.000 – 5.990	2.000 – 5.990	13 – 19	1.2	•	•	•	•	•
3.000 – 9.990	3.000 – 9.990	3.000 – 7.990	3.000 – 7.990	13 – 19	1.6	•	•	•	•	•
6.000 – 12.990	6.000 – 12.990	3.000 – 9.990	3.000 – 9.990	13 – 19	1.9	•	•	•	•	•
10.000 – 15.990	10.000 – 15.990	6.000 – 12.990	6.000 – 12.990	19 – 25	2.9	•	•	•	•	•
13.000 – 19.990	13.000 – 19.990	10.000 – 15.990	10.000 – 15.990	19 – 25	2.9	•	•	•	•	•
18.000 – 24.990	18.000 – 24.990	13.000 – 19.990	13.000 – 19.990	19 – 25	2.9	•	•	•	•	•

Note: Other Dimension Not Listed above can be ground to your specifications.
 If in doubt please send us your drawing. 'D' tolerance is m5 or +0.005.
 Unless otherwise specified by customer all outside corners will be sharp.

How to order : **CBBH - H - V - P - W - B - L**
 Example : **TBBH - H2.000 - V2.000 - P1.500 - W1.500 - B8 - L40**

SOLID CARBIDE BLOCK PUNCHES



- TAPPED, RECTANGLE w/ CORNER RADIUS (**CBBJ**)
- TAPPED, RECTANGLE w/ CORNER RADIUS WITH TiCN COATING (**TBBJ**)

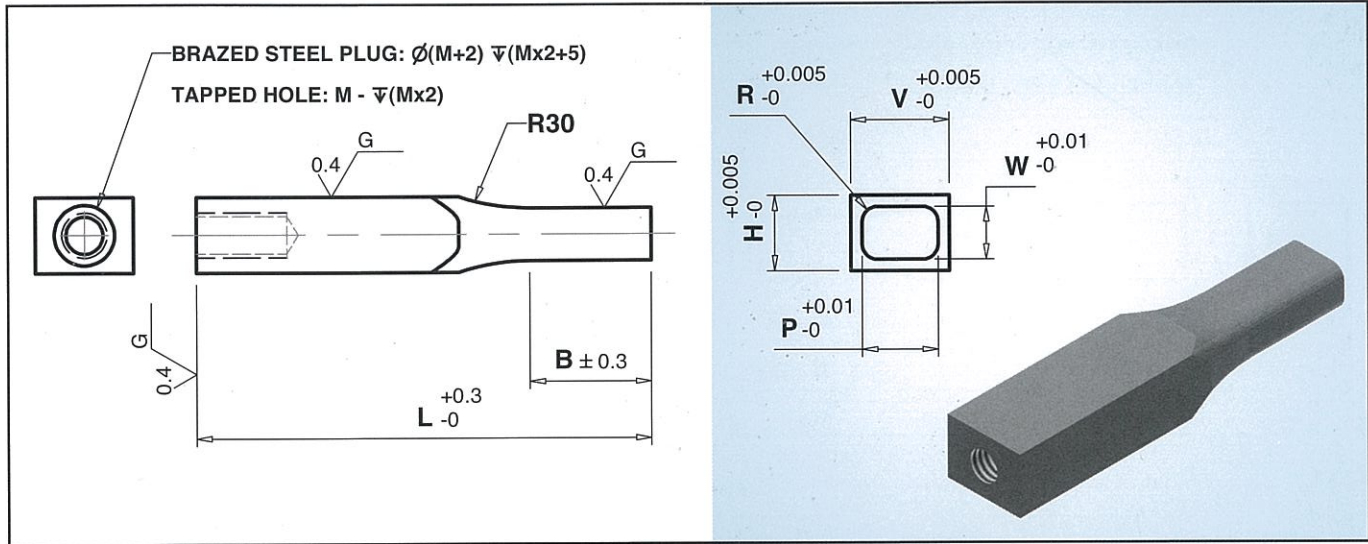

Shank Size		P Point Size		B Point Length	L - Length				
H	V	P	W		40	50	60	70	80
1.500 - 3.990	1.500 - 3.990	1.500 - 2.990	1.500 - 2.990	8 - 13	•	•	•		
2.000 - 4.990	2.000 - 4.990	1.500 - 3.990	1.500 - 3.990	8 - 13	•	•	•	•	
2.000 - 5.990	2.000 - 5.990	1.500 - 4.990	1.500 - 4.990	8 - 13	•	•	•	•	
3.000 - 7.990	3.000 - 7.990	2.000 - 5.990	2.000 - 5.990	13 - 19	•	•	•	•	•
3.000 - 9.990	3.000 - 9.990	3.000 - 7.990	3.000 - 7.990	13 - 19	•	•	•	•	•
6.000 - 12.990	6.000 - 12.990	3.000 - 9.990	3.000 - 9.990	13 - 19	•	•	•	•	•
10.000 - 15.990	10.000 - 15.990	6.000 - 12.990	6.000 - 12.990	19 - 25	•	•	•	•	•
13.000 - 19.990	13.000 - 19.990	10.000 - 15.990	10.000 - 15.990	19 - 25	•	•	•	•	•
18.000 - 24.990	18.000 - 24.990	13.000 - 19.990	13.000 - 19.990	19 - 25	•	•	•	•	•

Note: Other Dimension Not Listed above can be ground to your specifications.
 If in doubt please send us your drawing. 'D' tolerance is m5 or +0.005.
 Unless otherwise specified by customer all outside corners will be sharp.

*** $0.15 \leq R < W/2$

How to order : **CBBJ - H - V - P - W - B - L - R**

Example : **TBBJ - H2.000 - V2.000 - P1.500 - W1.500 - B8 - L40 - R0.15**

SOLID CARBIDE BLOCK PUNCHES



- TAPPED, RECTANGLE w/ CORNER RADIUS WITH AIR HOLE (CBBK)
- TAPPED, RECTANGLE w/ CORNER RADIUS WITH AIR HOLE WITH TiCN COATING (TBBK)

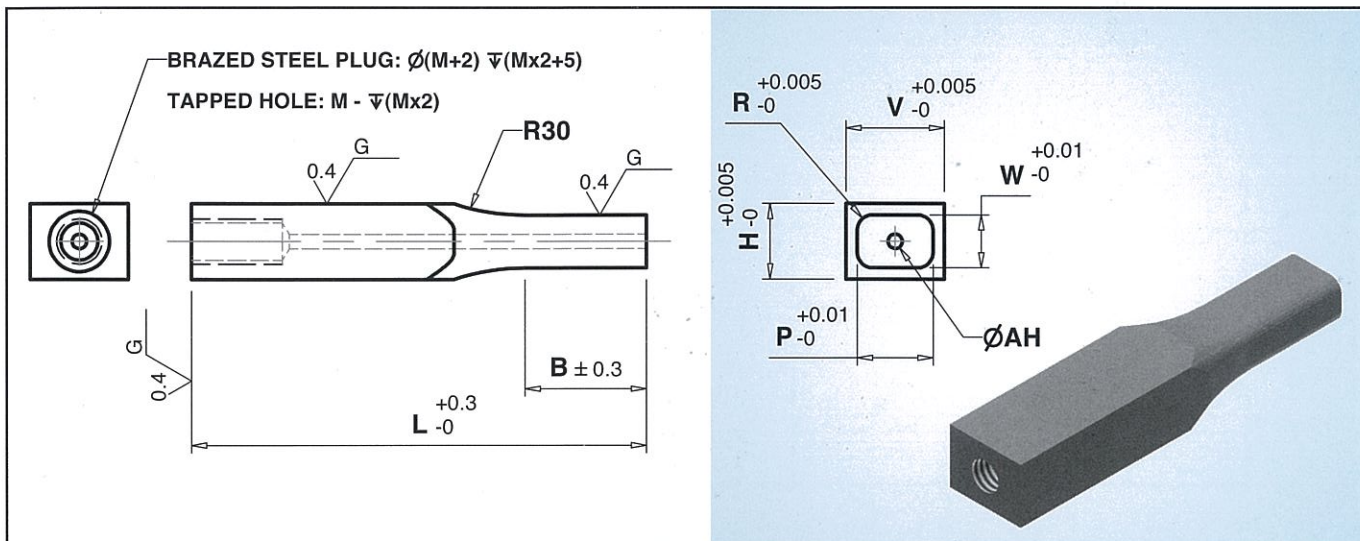

Shank Size		P Point Size		B Point Length	AH Air Hole	L – Length				
H	V	P	W			40	50	60	70	80
1.500 – 3.990	1.500 – 3.990	1.500 – 2.990	1.500 – 2.990	8 – 13	0.5	•	•	•		
2.000 – 4.990	2.000 – 4.990	1.500 – 3.990	1.500 – 3.990	8 – 13	0.8	•	•	•	•	
2.000 – 5.990	2.000 – 5.990	1.500 – 4.990	1.500 – 4.990	8 – 13	0.8	•	•	•	•	
3.000 – 7.990	3.000 – 7.990	2.000 – 5.990	2.000 – 5.990	13 – 19	1.2	•	•	•	•	•
3.000 – 9.990	3.000 – 9.990	3.000 – 7.990	3.000 – 7.990	13 – 19	1.6	•	•	•	•	•
6.000 – 12.990	6.000 – 12.990	3.000 – 9.990	3.000 – 9.990	13 – 19	1.9	•	•	•	•	•
10.000 – 15.990	10.000 – 15.990	6.000 – 12.990	6.000 – 12.990	19 – 25	2.9	•	•	•	•	•
13.000 – 19.990	13.000 – 19.990	10.000 – 15.990	10.000 – 15.990	19 – 25	2.9	•	•	•	•	•
18.000 – 24.990	18.000 – 24.990	13.000 – 19.990	13.000 – 19.990	19 – 25	2.9	•	•	•	•	•

Note: Other Dimension Not Listed above can be ground to your specifications.
 If in doubt please send us your drawing. 'D' tolerance is m5 or +0.005.
 Unless otherwise specified by customer all outside corners will be sharp.

*** $0.15 \leq R < W/2$

How to order : **CBBK – H – V – P – W – B – L – R**

Example : **TBBK – H2.000 – V2.000 – P1.500 – W1.500 – B8 – L40 – R0.15**

SOLID CARBIDE BLOCK PUNCHES

- SINGLE FLANGE, RECTANGLE (CBCC)
- SINGLE FLANGE, RECTANGLE WITH TiCN COATING (TBCC)

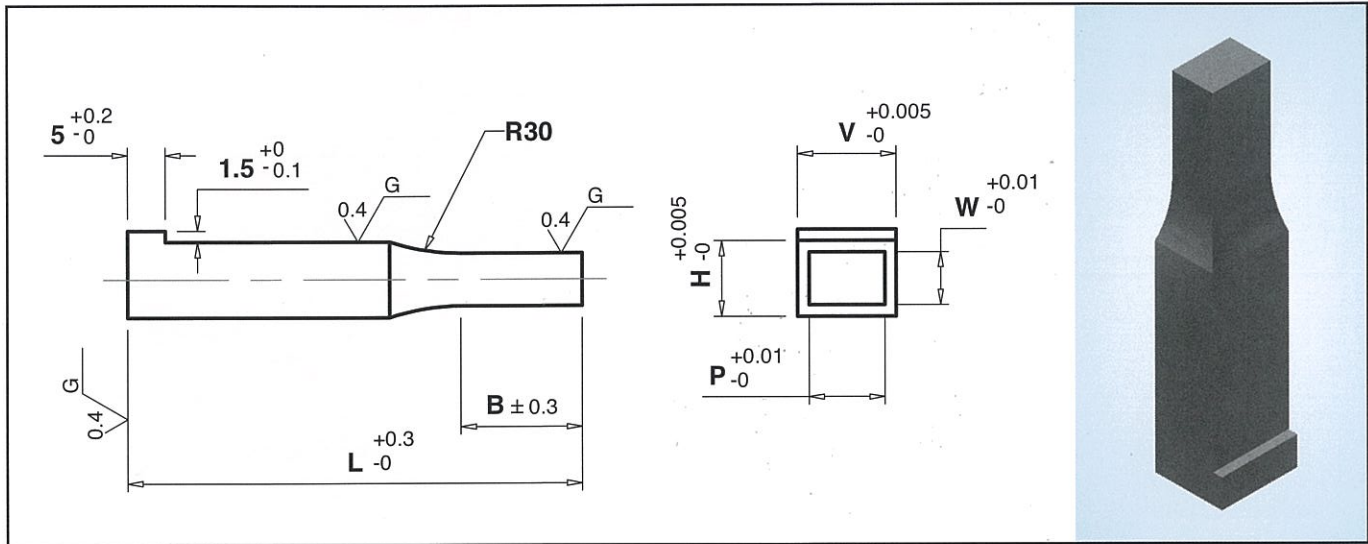

Shank Size		P Point Size		B Point Length	L – Length				
H	V	P	W		40	50	60	70	80
1.500 – 3.990	1.500 – 3.990	1.500 – 2.990	1.500 – 2.990	8 – 13	•	•	•		
2.000 – 4.990	2.000 – 4.990	1.500 – 3.990	1.500 – 3.990	8 – 13	•	•	•	•	
2.000 – 5.990	2.000 – 5.990	1.500 – 4.990	1.500 – 4.990	8 – 13	•	•	•	•	
3.000 – 7.990	3.000 – 7.990	2.000 – 5.990	2.000 – 5.990	13 – 19	•	•	•	•	•
3.000 – 9.990	3.000 – 9.990	3.000 – 7.990	3.000 – 7.990	13 – 19	•	•	•	•	•
6.000 – 12.990	6.000 – 12.990	3.000 – 9.990	3.000 – 9.990	13 – 19	•	•	•	•	•
10.000 – 15.990	10.000 – 15.990	6.000 – 12.990	6.000 – 12.990	19 – 25	•	•	•	•	•
13.000 – 19.990	13.000 – 19.990	10.000 – 15.990	10.000 – 15.990	19 – 25	•	•	•	•	•
18.000 – 24.990	18.000 – 24.990	13.000 – 19.990	13.000 – 19.990	19 – 25	•	•	•	•	•

Note: Other Dimension Not Listed above can be ground to your specifications.
 If in doubt please send us your drawing. 'D' tolerance is m5 or +0.005.
 Unless otherwise specified by customer all outside corners will be sharp.

How to order : **CBCC – H – V – P – W – B – L**

Example : **TBCC – H2.000 – V2.000 – P1.500 – W1.500 – B8 – L40**

SOLID CARBIDE BLOCK PUNCHES

- SINGLE FLANGE, RECTANGLE WITH AIR HOLE (**CBCD**)
- SINGLE FLANGE, RECTANGLE WITH AIR HOLE WITH TiCN COATING (**TBCD**)

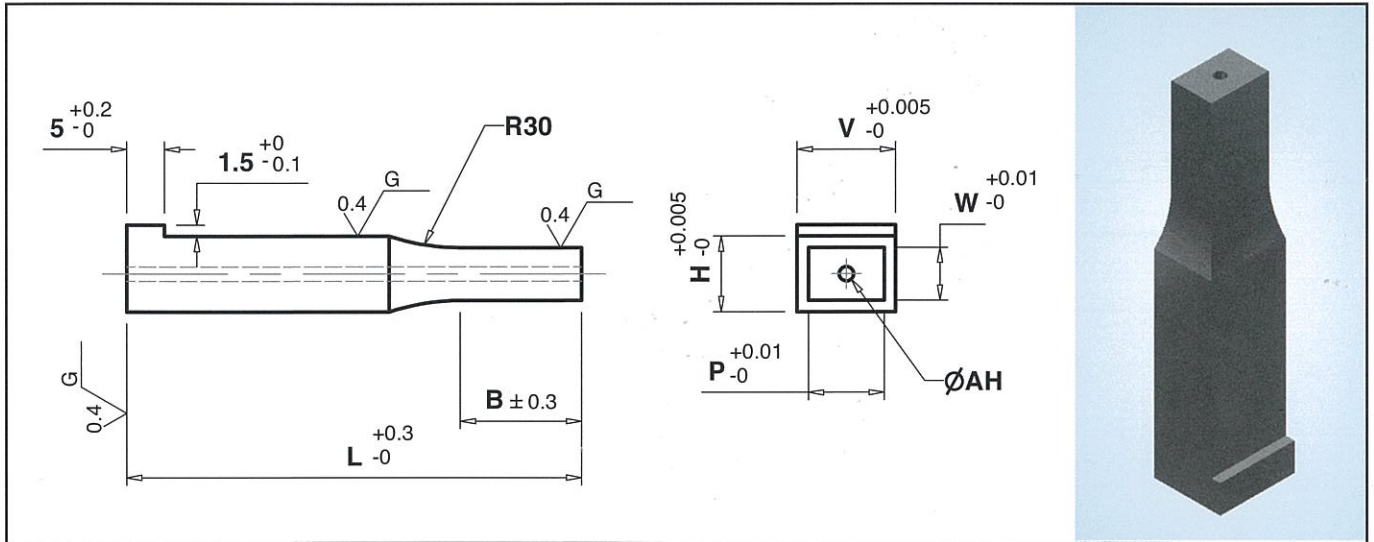

Shank Size		P Point Size		B Point Length	AH Air Hole	L – Length				
H	V	P	W			40	50	60	70	80
1.500 – 3.990	1.500 – 3.990	1.500 – 2.990	1.500 – 2.990	8 – 13	0.5	•	•	•		
2.000 – 4.990	2.000 – 4.990	1.500 – 3.990	1.500 – 3.990	8 – 13	0.8	•	•	•	•	
2.000 – 5.990	2.000 – 5.990	1.500 – 4.990	1.500 – 4.990	8 – 13	0.8	•	•	•	•	
3.000 – 7.990	3.000 – 7.990	2.000 – 5.990	2.000 – 5.990	13 – 19	1.2	•	•	•	•	•
3.000 – 9.990	3.000 – 9.990	3.000 – 7.990	3.000 – 7.990	13 – 19	1.6	•	•	•	•	•
6.000 – 12.990	6.000 – 12.990	3.000 – 9.990	3.000 – 9.990	13 – 19	1.9	•	•	•	•	•
10.000 – 15.990	10.000 – 15.990	6.000 – 12.990	6.000 – 12.990	19 – 25	2.9	•	•	•	•	•
13.000 – 19.990	13.000 – 19.990	10.000 – 15.990	10.000 – 15.990	19 – 25	2.9	•	•	•	•	•
18.000 – 24.990	18.000 – 24.990	13.000 – 19.990	13.000 – 19.990	19 – 25	2.9	•	•	•	•	•

Note: Other Dimension Not Listed above can be ground to your specifications.
 If in doubt please send us your drawing. 'D' tolerance is m5 or +0.005.
 Unless otherwise specified by customer all outside corners will be sharp.

How to order : **CBCD – H – V – P – W – B – L**

Example : **TBCD – H2.000 – V2.000 – P1.500 – W1.500 – B8 – L40**

SOLID CARBIDE BLOCK PUNCHES

- SINGLE FLANGE, OBLONG (CBCE)
- SINGLE FLANGE, OBLONG WITH TiCN COATING (TBCE)

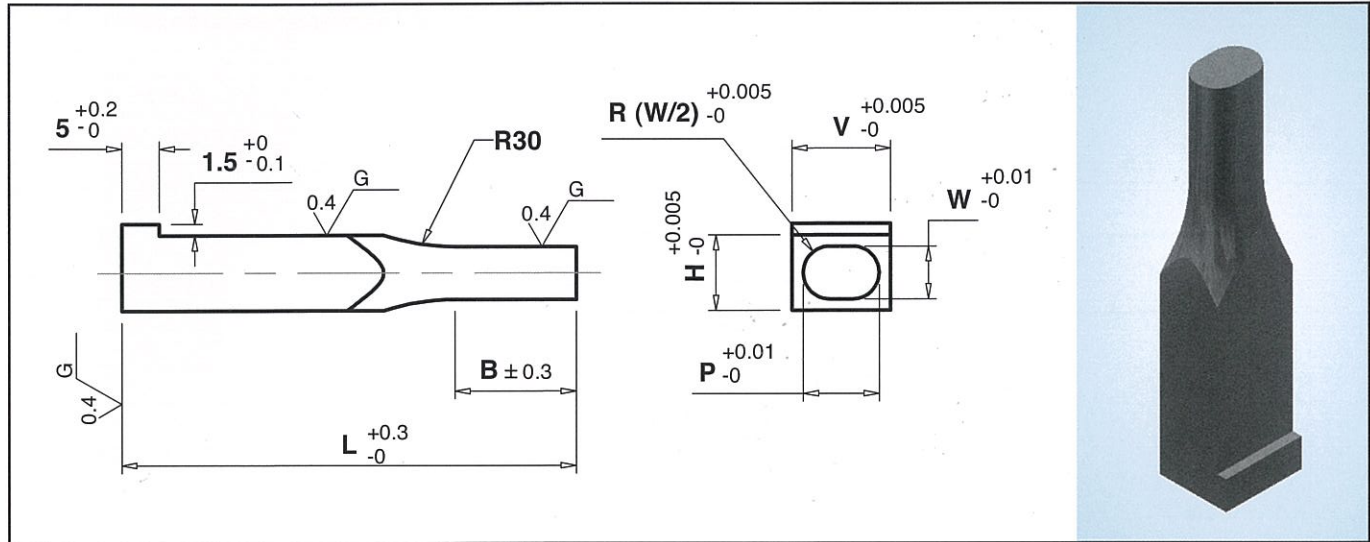

Shank Size		P Point Size		B Point Length	L – Length				
H	V	P	W		40	50	60	70	80
1.500 – 2.990	1.500 – 2.990	1.500 – 3.990	1.500 – 3.990	8 – 13	•	•	•		
1.500 – 3.990	1.500 – 3.990	2.000 – 4.990	2.000 – 4.990	8 – 13	•	•	•	•	
1.500 – 4.990	1.500 – 4.990	2.000 – 5.990	2.000 – 5.990	8 – 13	•	•	•	•	
2.000 – 5.990	2.000 – 5.990	3.000 – 7.990	3.000 – 7.990	13 – 19	•	•	•	•	•
3.000 – 7.990	3.000 – 7.990	3.000 – 9.990	3.000 – 9.990	13 – 19	•	•	•	•	•
3.000 – 9.990	3.000 – 9.990	6.000 – 12.990	6.000 – 12.990	13 – 19	•	•	•	•	•
6.000 – 12.990	6.000 – 12.990	10.000 – 15.990	10.000 – 15.990	19 – 25	•	•	•	•	•
10.000 – 15.990	10.000 – 15.990	13.000 – 19.990	13.000 – 19.990	19 – 25	•	•	•	•	•
13.000 – 19.990	13.000 – 19.990	18.000 – 24.990	18.000 – 24.990	19 – 25	•	•	•	•	•

Note: Other Dimension Not Listed above can be ground to your specifications.
 If in doubt please send us your drawing. 'D' tolerance is m5 or +0.005.
 Unless otherwise specified by customer all outside corners will be sharp.

How to order : **CBCE – H – V – P – W – B – L**
 Example : **TBCE – H2.000 – V2.000 – P1.500 – W1.500 – B8 – L40**

SOLID CARBIDE BLOCK PUNCHES

- SINGLE FLANGE, OBLONG WITH AIR HOLE (**CBCF**)
- SINGLE FLANGE, OBLONG WITH AIR HOLE WITH TiCN COATING (**TBCF**)

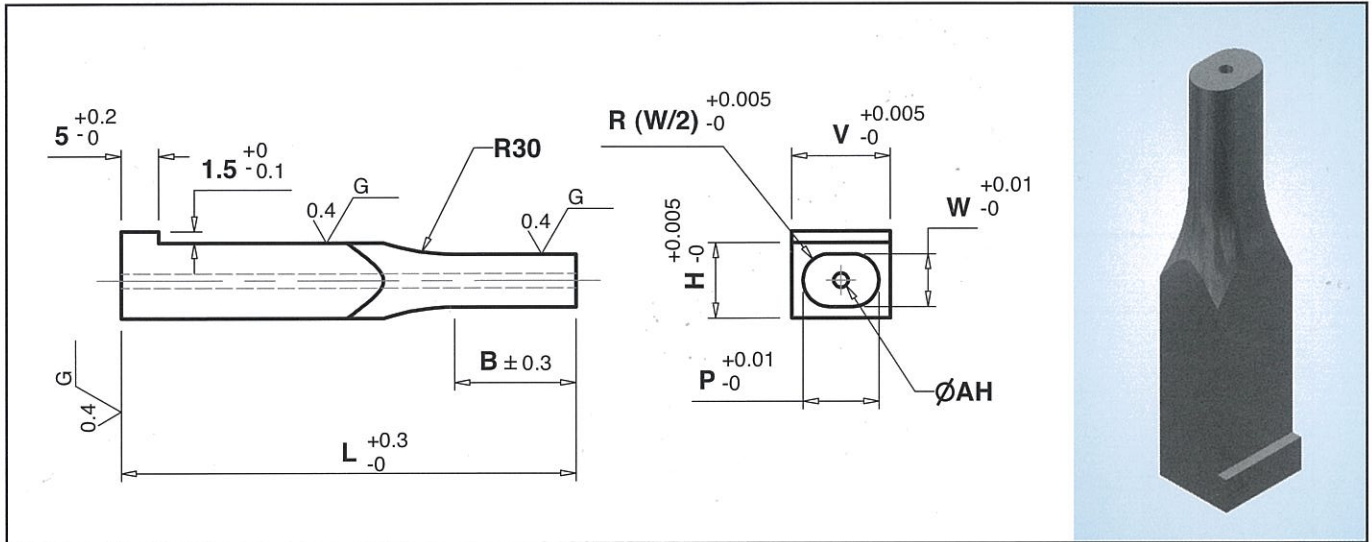

Shank Size		P Point Size		B Point Length	AH Air Hole	L – Length				
H	V	P	W			40	50	60	70	80
1.500 – 3.990	1.500 – 3.990	1.500 – 2.990	1.500 – 2.990	8 – 13	0.5	•	•	•		
2.000 – 4.990	2.000 – 4.990	1.500 – 3.990	1.500 – 3.990	8 – 13	0.8	•	•	•	•	
2.000 – 5.990	2.000 – 5.990	1.500 – 4.990	1.500 – 4.990	8 – 13	0.8	•	•	•	•	
3.000 – 7.990	3.000 – 7.990	2.000 – 5.990	2.000 – 5.990	13 – 19	1.2	•	•	•	•	•
3.000 – 9.990	3.000 – 9.990	3.000 – 7.990	3.000 – 7.990	13 – 19	1.6	•	•	•	•	•
6.000 – 12.990	6.000 – 12.990	3.000 – 9.990	3.000 – 9.990	13 – 19	1.9	•	•	•	•	•
10.000 – 15.990	10.000 – 15.990	6.000 – 12.990	6.000 – 12.990	19 – 25	2.9	•	•	•	•	•
13.000 – 19.990	13.000 – 19.990	10.000 – 15.990	10.000 – 15.990	19 – 25	2.9	•	•	•	•	•
18.000 – 24.990	18.000 – 24.990	13.000 – 19.990	13.000 – 19.990	19 – 25	2.9	•	•	•	•	•

Note: Other Dimension Not Listed above can be ground to your specifications.
 If in doubt please send us your drawing. 'D' tolerance is m5 or +0.005.
 Unless otherwise specified by customer all outside corners will be sharp.

How to order : **CBCF – H – V – P – W – B – L**
 Example : **TBCF – H2.000 – V2.000 – P1.500 – W1.500 – B8 – L40**

SOLID CARBIDE BLOCK PUNCHES

- SINGLE FLANGE, FLATTED ROUND (CBCG)
- SINGLE FLANGE, FLATTED ROUND WITH TiCN COATING (TBCG)

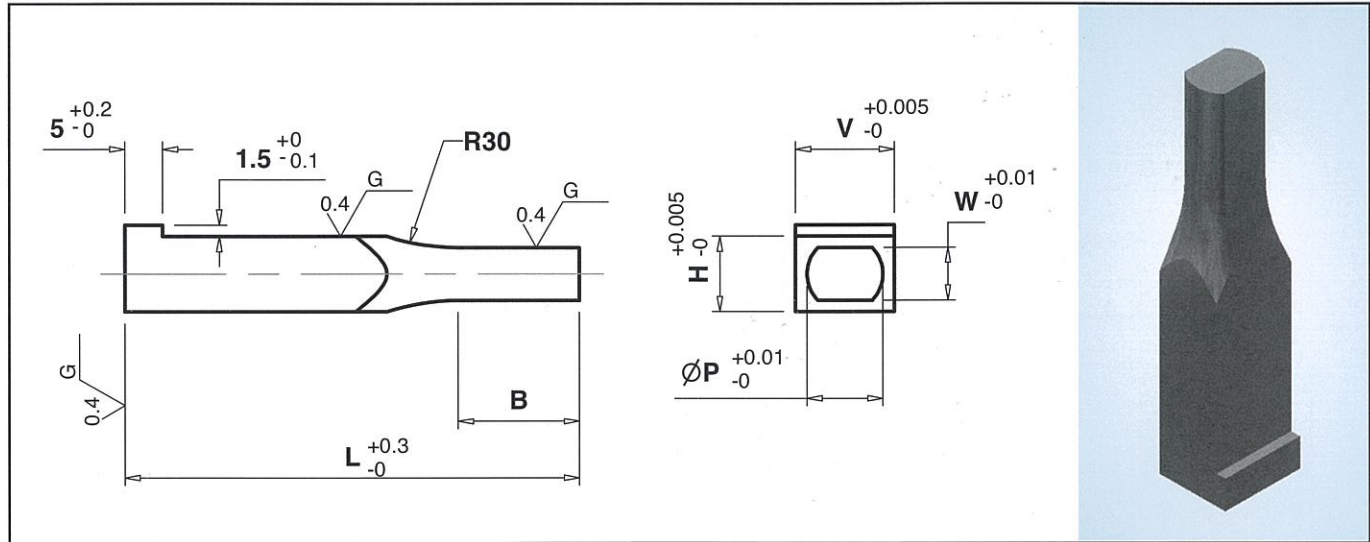

Shank Size		P Point Size		B Point Length	L – Length				
H	V	P	W		40	50	60	70	80
1.500 – 2.990	1.500 – 2.990	1.500 – 3.990	1.500 – 3.990	8 – 13	•	•	•		
1.500 – 3.990	1.500 – 3.990	2.000 – 4.990	2.000 – 4.990	8 – 13	•	•	•	•	
1.500 – 4.990	1.500 – 4.990	2.000 – 5.990	2.000 – 5.990	8 – 13	•	•	•	•	
2.000 – 5.990	2.000 – 5.990	3.000 – 7.990	3.000 – 7.990	13 – 19	•	•	•	•	•
3.000 – 7.990	3.000 – 7.990	3.000 – 9.990	3.000 – 9.990	13 – 19	•	•	•	•	•
3.000 – 9.990	3.000 – 9.990	6.000 – 12.990	6.000 – 12.990	13 – 19	•	•	•	•	•
6.000 – 12.990	6.000 – 12.990	10.000 – 15.990	10.000 – 15.990	19 – 25	•	•	•	•	•
10.000 – 15.990	10.000 – 15.990	13.000 – 19.990	13.000 – 19.990	19 – 25	•	•	•	•	•
13.000 – 19.990	13.000 – 19.990	18.000 – 24.990	18.000 – 24.990	19 – 25	•	•	•	•	•

Note: Other Dimension Not Listed above can be ground to your specifications.
 If in doubt please send us your drawing. 'D' tolerance is m5 or +0.005.
 Unless otherwise specified by customer all outside corners will be sharp.

How to order : – H – V – P – W – B – L
 Example : TBCF – H2.000 – V2.000 – P1.500 – W1.500 – B8 – L40

SOLID CARBIDE BLOCK PUNCHES



- SINGLE FLANGE, FLATTED ROUND WITH AIR HOLE (**CBCH**)
- SINGLE FLANGE, FLATTED ROUND WITH AIR HOLE WITH TiCN COATING (**TBCH**)

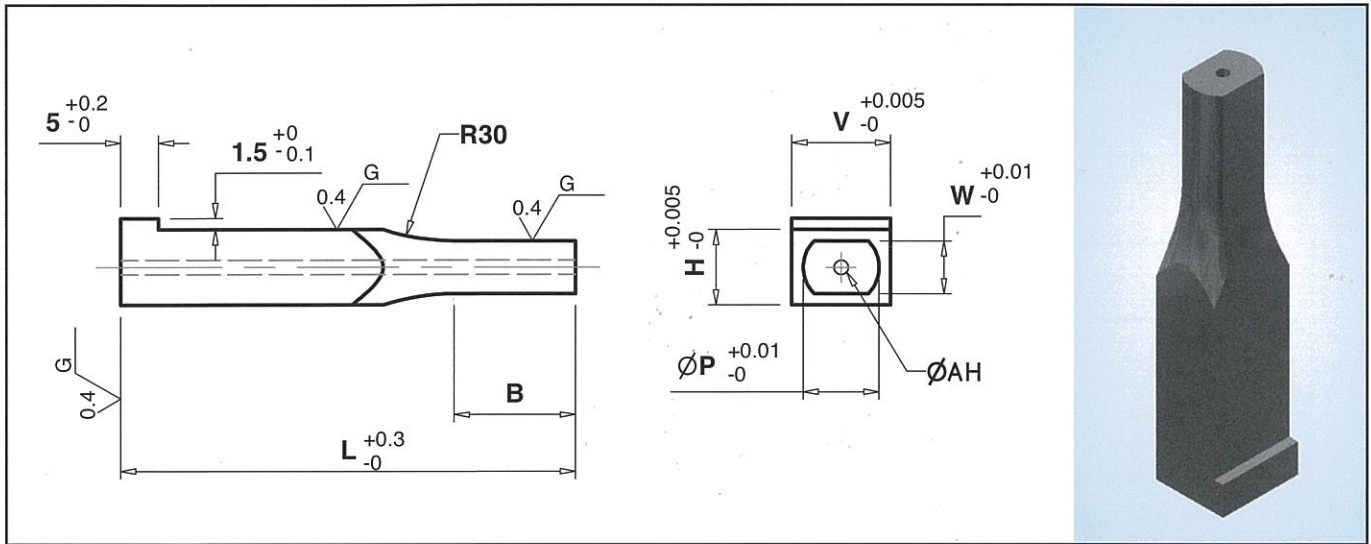

Shank Size		P Point Size		B Point Length	AH Air Hole	L – Length				
H	V	P	W			40	50	60	70	80
1.500 – 3.990	1.500 – 3.990	1.500 – 2.990	1.500 – 2.990	8 – 13	0.5	•	•	•		
2.000 – 4.990	2.000 – 4.990	1.500 – 3.990	1.500 – 3.990	8 – 13	0.8	•	•	•	•	
2.000 – 5.990	2.000 – 5.990	1.500 – 4.990	1.500 – 4.990	8 – 13	0.8	•	•	•	•	
3.000 – 7.990	3.000 – 7.990	2.000 – 5.990	2.000 – 5.990	13 – 19	1.2	•	•	•	•	•
3.000 – 9.990	3.000 – 9.990	3.000 – 7.990	3.000 – 7.990	13 – 19	1.6	•	•	•	•	•
6.000 – 12.990	6.000 – 12.990	3.000 – 9.990	3.000 – 9.990	13 – 19	1.9	•	•	•	•	•
10.000 – 15.990	10.000 – 15.990	6.000 – 12.990	6.000 – 12.990	19 – 25	2.9	•	•	•	•	•
13.000 – 19.990	13.000 – 19.990	10.000 – 15.990	10.000 – 15.990	19 – 25	2.9	•	•	•	•	•
18.000 – 24.990	18.000 – 24.990	13.000 – 19.990	13.000 – 19.990	19 – 25	2.9	•	•	•	•	•

Note: Other Dimension Not Listed above can be ground to your specifications.
 If in doubt please send us your drawing. 'D' tolerance is m5 or +0.005.
 Unless otherwise specified by customer all outside corners will be sharp.

How to order : **CBCH – H – V – P – W – B – L**

Example : **TBCH – H2.000 – V2.000 – P1.500 – W1.500 – B8 – L40**

SOLID CARBIDE BLOCK PUNCHES

- SINGLE FLANGE, RECTANGLE w/ CORNER RADIUS (CBCJ)
- SINGLE FLANGE, RECTANGLE w/ CORNER RADIUS WITH TiCN COATING (TBCJ)

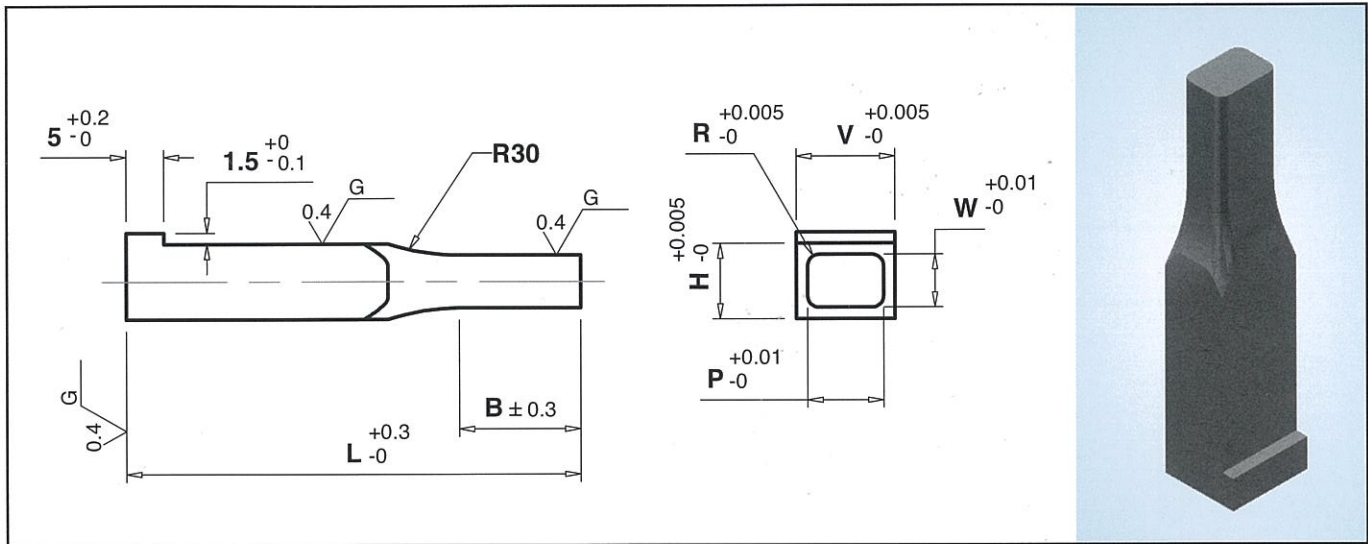

Shank Size		P Point Size		B Point Length	L – Length				
H	V	P	W		40	50	60	70	80
1.500 – 3.990	1.500 – 3.990	1.500 – 2.990	1.500 – 2.990	8 – 13	•	•	•		
2.000 – 4.990	2.000 – 4.990	1.500 – 3.990	1.500 – 3.990	8 – 13	•	•	•	•	
2.000 – 5.990	2.000 – 5.990	1.500 – 4.990	1.500 – 4.990	8 – 13	•	•	•	•	
3.000 – 7.990	3.000 – 7.990	2.000 – 5.990	2.000 – 5.990	13 – 19	•	•	•	•	•
3.000 – 9.990	3.000 – 9.990	3.000 – 7.990	3.000 – 7.990	13 – 19	•	•	•	•	•
6.000 – 12.990	6.000 – 12.990	3.000 – 9.990	3.000 – 9.990	13 – 19	•	•	•	•	•
10.000 – 15.990	10.000 – 15.990	6.000 – 12.990	6.000 – 12.990	19 – 25	•	•	•	•	•
13.000 – 19.990	13.000 – 19.990	10.000 – 15.990	10.000 – 15.990	19 – 25	•	•	•	•	•
18.000 – 24.990	18.000 – 24.990	13.000 – 19.990	13.000 – 19.990	19 – 25	•	•	•	•	•

Note: Other Dimension Not Listed above can be ground to your specifications.
 If in doubt please send us your drawing. 'D' tolerance is m5 or +0.005.
 Unless otherwise specified by customer all outside corners will be sharp.

*** $0.15 \leq R < W/2$

How to order : **CBCJ – H – V – P – W – B – L – R**

Example : **TBCJ – H2.000 – V2.000 – P1.500 – W1.500 – B8 – L40 – R0.15**

SOLID CARBIDE BLOCK PUNCHES

- SINGLE FLANGE, RECTANGLE w/ CORNER RADIUS WITH AIR HOLE (**CBCK**)
- SINGLE FLANGE, RECTANGLE w/ CORNER RADIUS WITH AIR HOLE WITH TiCN COATING (**TBCK**)

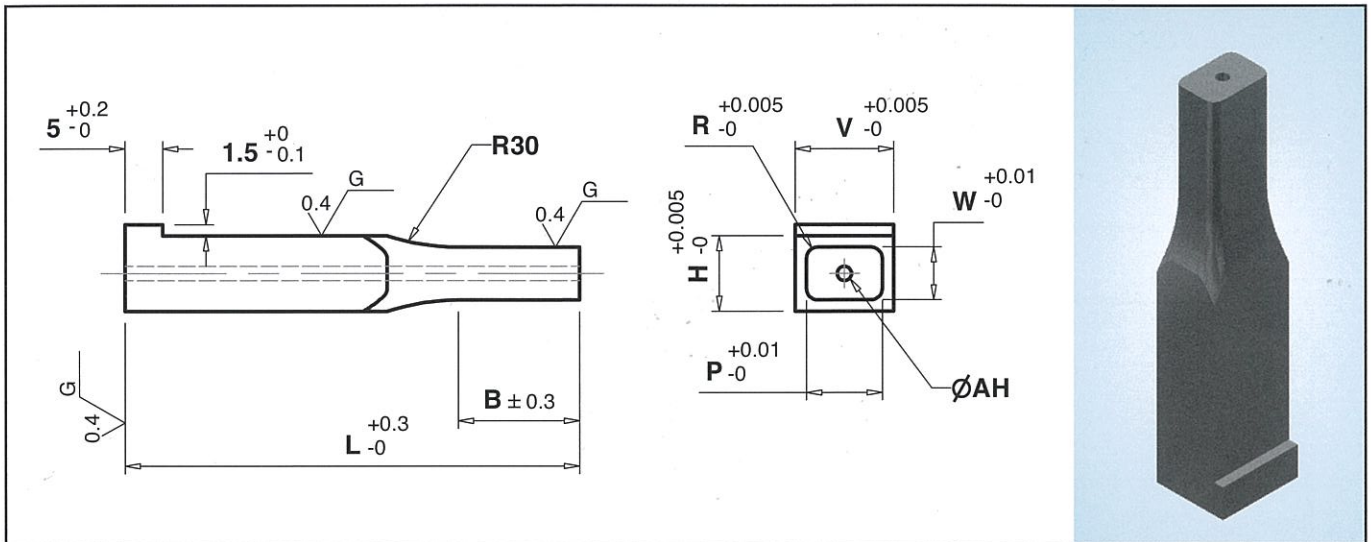

Shank Size		P Point Size		B Point Length	AH Air Hole	L – Length				
H	V	P	W			40	50	60	70	80
1.500 – 3.990	1.500 – 3.990	1.500 – 2.990	1.500 – 2.990	8 – 13	0.5	•	•	•		
2.000 – 4.990	2.000 – 4.990	1.500 – 3.990	1.500 – 3.990	8 – 13	0.8	•	•	•	•	
2.000 – 5.990	2.000 – 5.990	1.500 – 4.990	1.500 – 4.990	8 – 13	0.8	•	•	•	•	
3.000 – 7.990	3.000 – 7.990	2.000 – 5.990	2.000 – 5.990	13 – 19	1.2	•	•	•	•	•
3.000 – 9.990	3.000 – 9.990	3.000 – 7.990	3.000 – 7.990	13 – 19	1.6	•	•	•	•	•
6.000 – 12.990	6.000 – 12.990	3.000 – 9.990	3.000 – 9.990	13 – 19	1.9	•	•	•	•	•
10.000 – 15.990	10.000 – 15.990	6.000 – 12.990	6.000 – 12.990	19 – 25	2.9	•	•	•	•	•
13.000 – 19.990	13.000 – 19.990	10.000 – 15.990	10.000 – 15.990	19 – 25	2.9	•	•	•	•	•
18.000 – 24.990	18.000 – 24.990	13.000 – 19.990	13.000 – 19.990	19 – 25	2.9	•	•	•	•	•

Note: Other Dimension Not Listed above can be ground to your specifications.
 If in doubt please send us your drawing. 'D' tolerance is m5 or +0.005.
 Unless otherwise specified by customer all outside corners will be sharp.

*** $0.15 \leq R < W/2$

How to order : **CBCK – H – V – P – W – B – L – R**

Example : **TBCK – H2.000 – V2.000 – P1.500 – W1.500 – B8 – L40 – R0.15**

SOLID CARBIDE BLOCK PUNCHES



- DOUBLE FLANGE, RECTANGLE (CBDC)
- DOUBLE FLANGE RECTANGLE WITH TiCN COATING (TBDC)

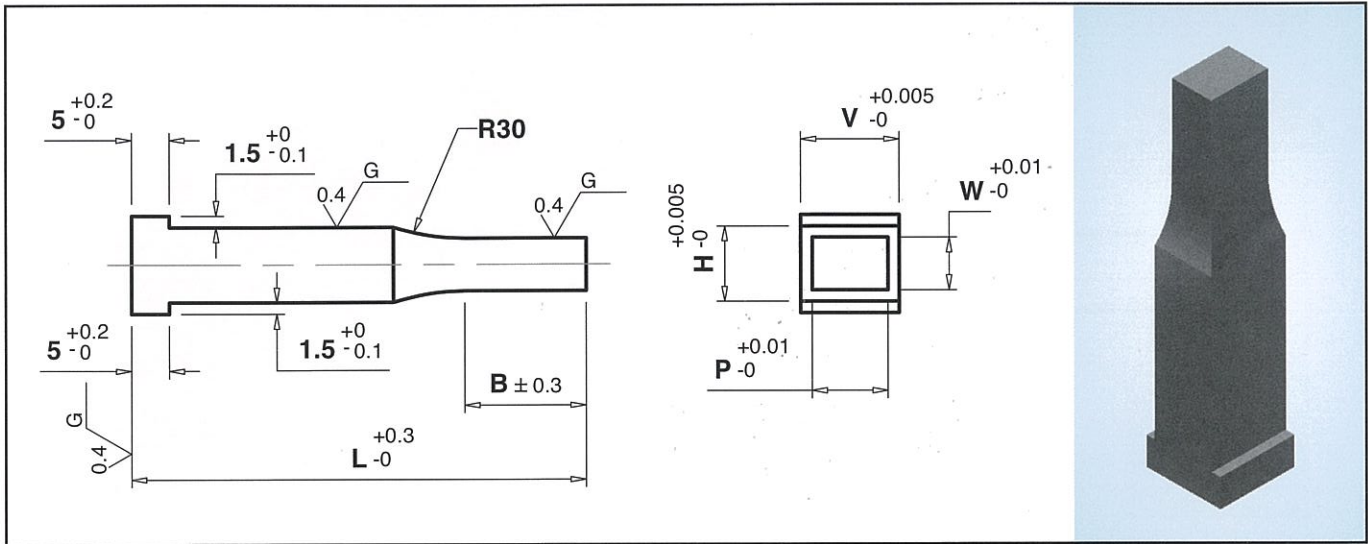

Shank Size		P Point Size		B Point Length	L – Length				
H	V	P	W		40	50	60	70	80
1.500 – 3.990	1.500 – 3.990	1.500 – 2.990	1.500 – 2.990	8 – 13	•	•	•		
2.000 – 4.990	2.000 – 4.990	1.500 – 3.990	1.500 – 3.990	8 – 13	•	•	•	•	
2.000 – 5.990	2.000 – 5.990	1.500 – 4.990	1.500 – 4.990	8 – 13	•	•	•	•	
3.000 – 7.990	3.000 – 7.990	2.000 – 5.990	2.000 – 5.990	13 – 19	•	•	•	•	•
3.000 – 9.990	3.000 – 9.990	3.000 – 7.990	3.000 – 7.990	13 – 19	•	•	•	•	•
6.000 – 12.990	6.000 – 12.990	3.000 – 9.990	3.000 – 9.990	13 – 19	•	•	•	•	•
10.000 – 15.990	10.000 – 15.990	6.000 – 12.990	6.000 – 12.990	19 – 25	•	•	•	•	•
13.000 – 19.990	13.000 – 19.990	10.000 – 15.990	10.000 – 15.990	19 – 25	•	•	•	•	•
18.000 – 24.990	18.000 – 24.990	13.000 – 19.990	13.000 – 19.990	19 – 25	•	•	•	•	•

Note: Other Dimension Not Listed above can be ground to your specifications.
 If in doubt please send us your drawing. 'D' tolerance is m5 or +0.005.
 Unless otherwise specified by customer all outside corners will be sharp.

How to order : **CBDC – H – V – P – W – B – L**

Example : **TBDC – H2.000 – V2.000 – P1.500 – W1.500 – B8 – L40**

SOLID CARBIDE BLOCK PUNCHES

- DOUBLE FLANGE, RECTANGLE WITH AIR HOLE (**CBDD**)
- DOUBLE FLANGE, RECTANGLE WITH AIR HOLE WITH TiCN COATING (**TBDD**)

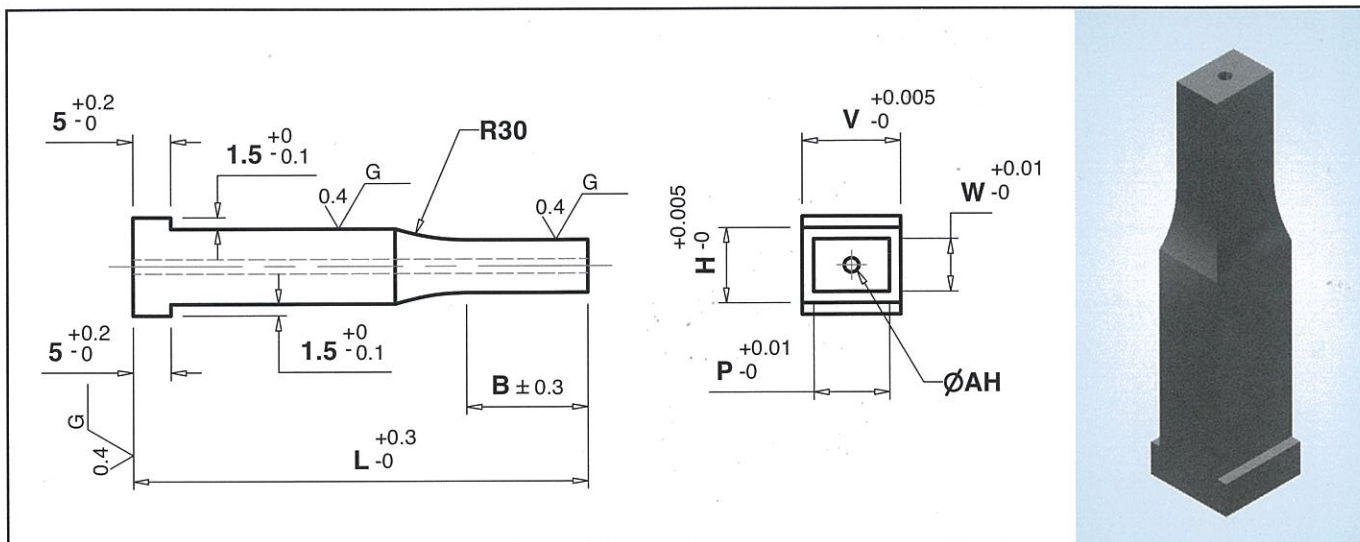

Shank Size		P Point Size		B Point Length	AH Air Hole	L – Length				
H	V	P	W			40	50	60	70	80
1.500 – 3.990	1.500 – 3.990	1.500 – 2.990	1.500 – 2.990	8 – 13	0.5	•	•	•		
2.000 – 4.990	2.000 – 4.990	1.500 – 3.990	1.500 – 3.990	8 – 13	0.8	•	•	•	•	
2.000 – 5.990	2.000 – 5.990	1.500 – 4.990	1.500 – 4.990	8 – 13	0.8	•	•	•	•	
3.000 – 7.990	3.000 – 7.990	2.000 – 5.990	2.000 – 5.990	13 – 19	1.2	•	•	•	•	•
3.000 – 9.990	3.000 – 9.990	3.000 – 7.990	3.000 – 7.990	13 – 19	1.6	•	•	•	•	•
6.000 – 12.990	6.000 – 12.990	3.000 – 9.990	3.000 – 9.990	13 – 19	1.9	•	•	•	•	•
10.000 – 15.990	10.000 – 15.990	6.000 – 12.990	6.000 – 12.990	19 – 25	2.9	•	•	•	•	•
13.000 – 19.990	13.000 – 19.990	10.000 – 15.990	10.000 – 15.990	19 – 25	2.9	•	•	•	•	•
18.000 – 24.990	18.000 – 24.990	13.000 – 19.990	13.000 – 19.990	19 – 25	2.9	•	•	•	•	•

Note: Other Dimension Not Listed above can be ground to your specifications.
 If in doubt please send us your drawing. 'D' tolerance is m5 or +0.005.
 Unless otherwise specified by customer all outside corners will be sharp.

How to order : **CBDD – H – V – P – W – B – L**

Example : **TBDD – H2.000 – V2.000 – P1.500 – W1.500 – B8 – L40**

SOLID CARBIDE BLOCK PUNCHES



- DOUBLE FLANGE, OBLONG (CBDE)
- DOUBLE FLANGE, OBLONG WITH TiCN COATING (TBDE)

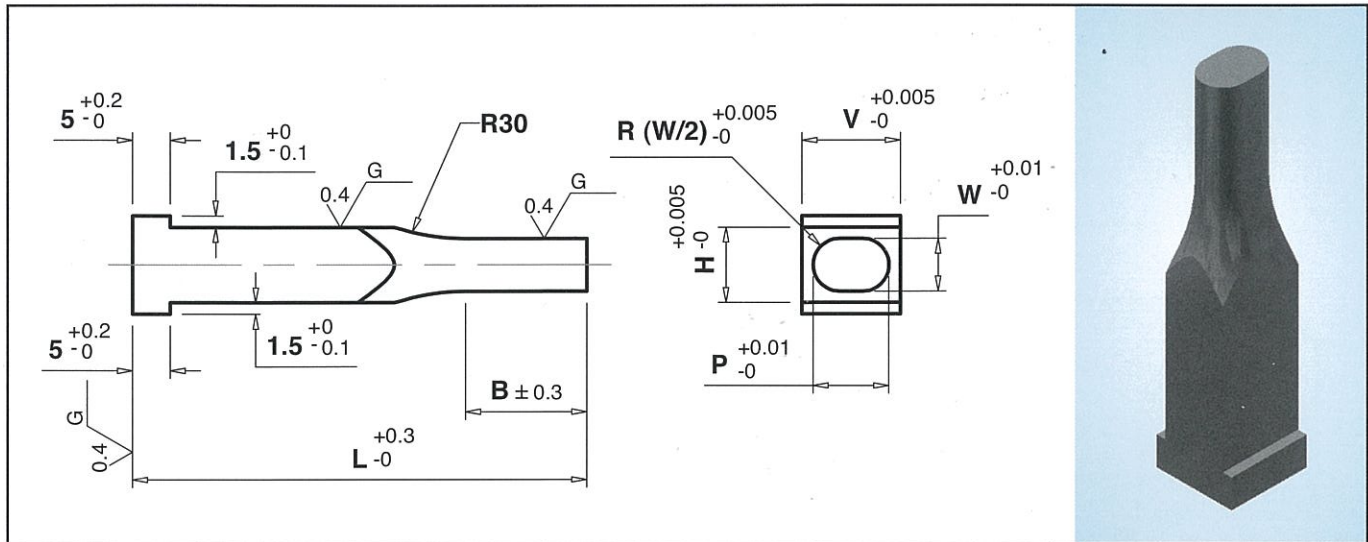

Shank Size		P Point Size		B Point Length	L – Length				
H	V	P	W		40	50	60	70	80
1.500 – 3.990	1.500 – 3.990	1.500 – 2.990	1.500 – 2.990	8 – 13	•	•	•		
2.000 – 4.990	2.000 – 4.990	1.500 – 3.990	1.500 – 3.990	8 – 13	•	•	•	•	
2.000 – 5.990	2.000 – 5.990	1.500 – 4.990	1.500 – 4.990	8 – 13	•	•	•	•	
3.000 – 7.990	3.000 – 7.990	2.000 – 5.990	2.000 – 5.990	13 – 19	•	•	•	•	•
3.000 – 9.990	3.000 – 9.990	3.000 – 7.990	3.000 – 7.990	13 – 19	•	•	•	•	•
6.000 – 12.990	6.000 – 12.990	3.000 – 9.990	3.000 – 9.990	13 – 19	•	•	•	•	•
10.000 – 15.990	10.000 – 15.990	6.000 – 12.990	6.000 – 12.990	19 – 25	•	•	•	•	•
13.000 – 19.990	13.000 – 19.990	10.000 – 15.990	10.000 – 15.990	19 – 25	•	•	•	•	•
18.000 – 24.990	18.000 – 24.990	13.000 – 19.990	13.000 – 19.990	19 – 25	•	•	•	•	•

Note: Other Dimension Not Listed above can be ground to your specifications.
 If in doubt please send us your drawing. 'D' tolerance is m5 or +0.005.
 Unless otherwise specified by customer all outside corners will be sharp.

How to order : **CBDE – H – V – P – W – B – L**
 Example : **TBDE – H2.000 – V2.000 – P1.500 – W1.500 – B8 – L40**

SOLID CARBIDE BLOCK PUNCHES



- DOUBLE FLANGE, OBLONG WITH AIR HOLE (**CBDF**)
- DOUBLE FLANGE, OBLONG WITH AIR HOLE WITH TiCN COATING (**TBDF**)

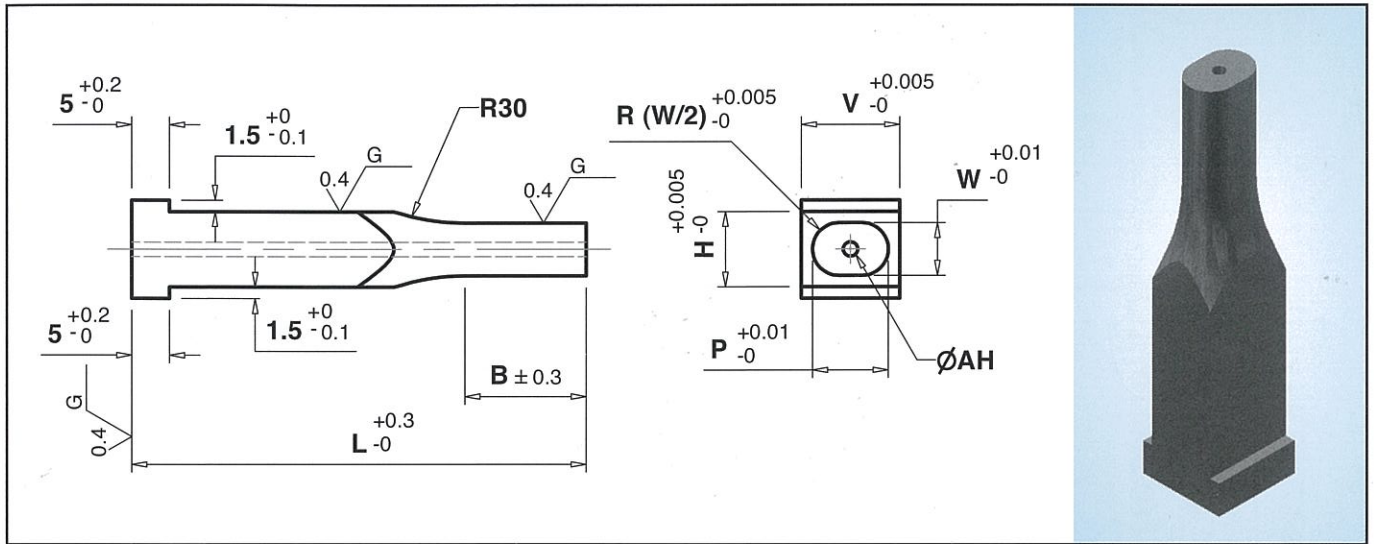

Shank Size		P Point Size		B Point Length	AH Air Hole	L – Length				
H	V	P	W			40	50	60	70	80
1.500 – 3.990	1.500 – 3.990	1.500 – 2.990	1.500 – 2.990	8 – 13	0.5	•	•	•		
2.000 – 4.990	2.000 – 4.990	1.500 – 3.990	1.500 – 3.990	8 – 13	0.8	•	•	•	•	
2.000 – 5.990	2.000 – 5.990	1.500 – 4.990	1.500 – 4.990	8 – 13	0.8	•	•	•	•	
3.000 – 7.990	3.000 – 7.990	2.000 – 5.990	2.000 – 5.990	13 – 19	1.2	•	•	•	•	•
3.000 – 9.990	3.000 – 9.990	3.000 – 7.990	3.000 – 7.990	13 – 19	1.6	•	•	•	•	•
6.000 – 12.990	6.000 – 12.990	3.000 – 9.990	3.000 – 9.990	13 – 19	1.9	•	•	•	•	•
10.000 – 15.990	10.000 – 15.990	6.000 – 12.990	6.000 – 12.990	19 – 25	2.9	•	•	•	•	•
13.000 – 19.990	13.000 – 19.990	10.000 – 15.990	10.000 – 15.990	19 – 25	2.9	•	•	•	•	•
18.000 – 24.990	18.000 – 24.990	13.000 – 19.990	13.000 – 19.990	19 – 25	2.9	•	•	•	•	•

Note: Other Dimension Not Listed above can be ground to your specifications.
 If in doubt please send us your drawing. 'D' tolerance is m5 or +0.005.
 Unless otherwise specified by customer all outside corners will be sharp.

How to order : **CBDF – H – V – P – W – B – L**

Example : **TBDF – H2.000 – V2.000 – P1.500 – W1.500 – B8 – L40**

SOLID CARBIDE BLOCK PUNCHES

- DOUBLE FLANGE, FLATTED ROUND (**CBDG**)
- DOUBLE FLANGE, FLATTED ROUND WITH TiCN COATING (**TBDG**)

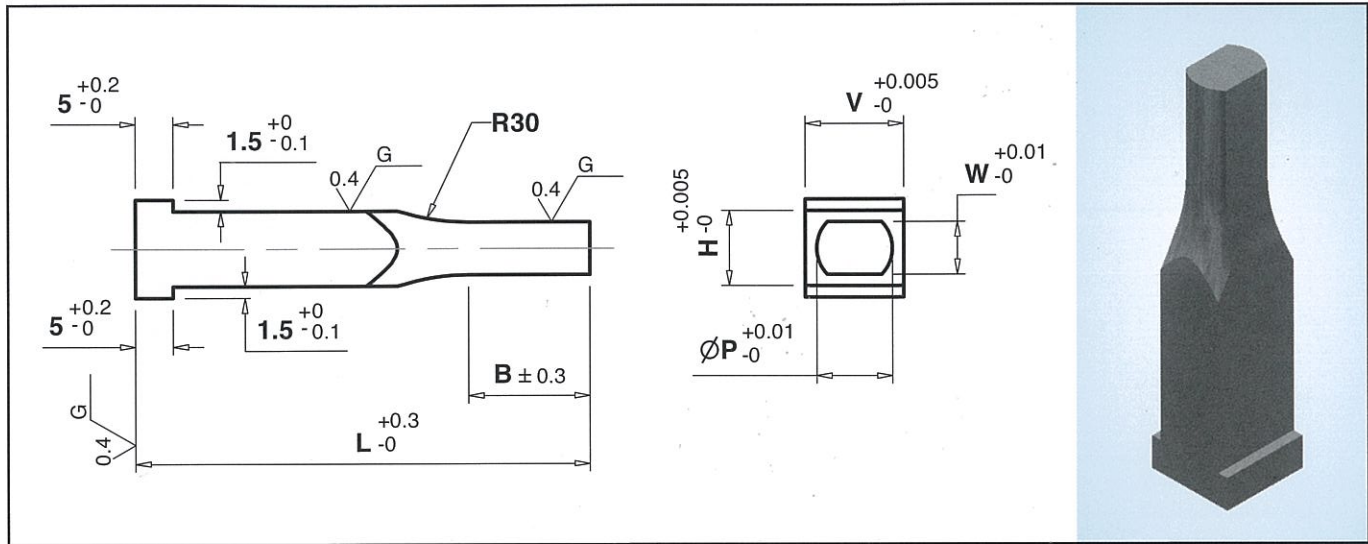

Shank Size		P Point Size		B Point Length	L – Length				
H	V	P	W		40	50	60	70	80
1.500 – 3.990	1.500 – 3.990	1.500 – 2.990	1.500 – 2.990	8 – 13	•	•	•		
2.000 – 4.990	2.000 – 4.990	1.500 – 3.990	1.500 – 3.990	8 – 13	•	•	•	•	
2.000 – 5.990	2.000 – 5.990	1.500 – 4.990	1.500 – 4.990	8 – 13	•	•	•	•	
3.000 – 7.990	3.000 – 7.990	2.000 – 5.990	2.000 – 5.990	13 – 19	•	•	•	•	•
3.000 – 9.990	3.000 – 9.990	3.000 – 7.990	3.000 – 7.990	13 – 19	•	•	•	•	•
6.000 – 12.990	6.000 – 12.990	3.000 – 9.990	3.000 – 9.990	13 – 19	•	•	•	•	•
10.000 – 15.990	10.000 – 15.990	6.000 – 12.990	6.000 – 12.990	19 – 25	•	•	•	•	•
13.000 – 19.990	13.000 – 19.990	10.000 – 15.990	10.000 – 15.990	19 – 25	•	•	•	•	•
18.000 – 24.990	18.000 – 24.990	13.000 – 19.990	13.000 – 19.990	19 – 25	•	•	•	•	•

Note: Other Dimension Not Listed above can be ground to your specifications.
 If in doubt please send us your drawing. 'D' tolerance is m5 or +0.005.
 Unless otherwise specified by customer all outside corners will be sharp.

How to order : **CBDG – H – V – P – W – B – L**

Example : **TBDG – H2.000 – V2.000 – P1.500 – W1.500 – B8 – L40**

SOLID CARBIDE BLOCK PUNCHES



- DOUBLE FLANGE, FLATTED ROUND WITH AIR HOLE (**CBDH**)
- DOUBLE FLANGE, FLATTED ROUND WITH AIR HOLE WITH TiCN COATING (**TBDH**)

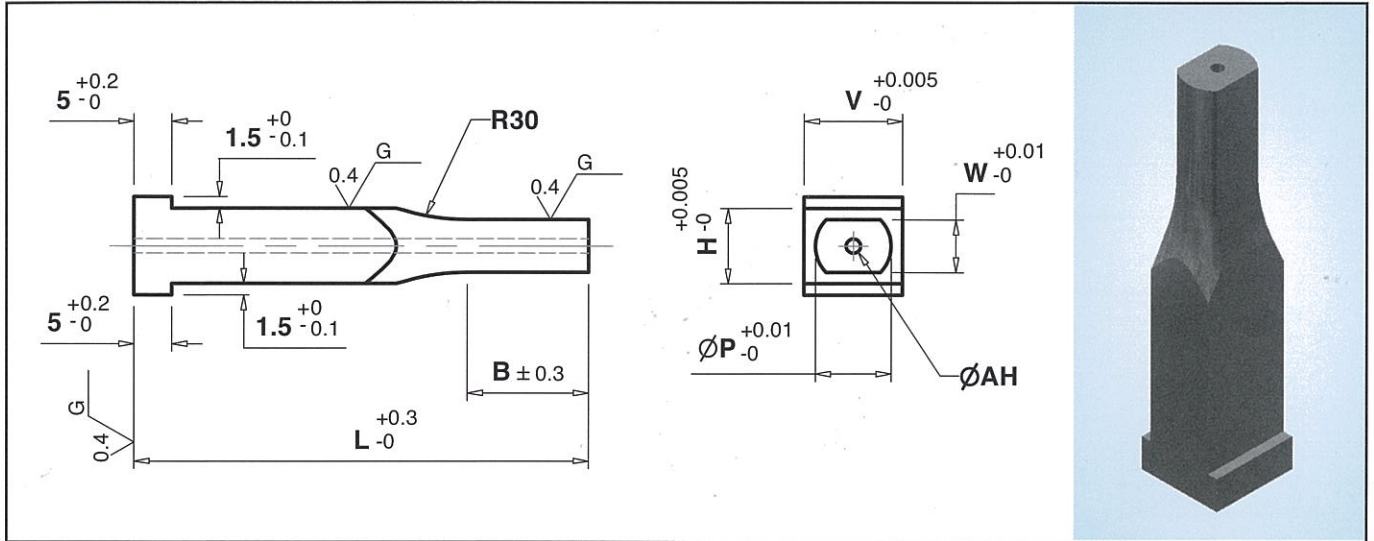

Shank Size		P Point Size		B Point Length	AH Air Hole	L – Length				
H	V	P	W			40	50	60	70	80
1.500 – 3.990	1.500 – 3.990	1.500 – 2.990	1.500 – 2.990	8 – 13	0.5	•	•	•		
2.000 – 4.990	2.000 – 4.990	1.500 – 3.990	1.500 – 3.990	8 – 13	0.8	•	•	•	•	
2.000 – 5.990	2.000 – 5.990	1.500 – 4.990	1.500 – 4.990	8 – 13	0.8	•	•	•	•	
3.000 – 7.990	3.000 – 7.990	2.000 – 5.990	2.000 – 5.990	13 – 19	1.2	•	•	•	•	•
3.000 – 9.990	3.000 – 9.990	3.000 – 7.990	3.000 – 7.990	13 – 19	1.6	•	•	•	•	•
6.000 – 12.990	6.000 – 12.990	3.000 – 9.990	3.000 – 9.990	13 – 19	1.9	•	•	•	•	•
10.000 – 15.990	10.000 – 15.990	6.000 – 12.990	6.000 – 12.990	19 – 25	2.9	•	•	•	•	•
13.000 – 19.990	13.000 – 19.990	10.000 – 15.990	10.000 – 15.990	19 – 25	2.9	•	•	•	•	•
18.000 – 24.990	18.000 – 24.990	13.000 – 19.990	13.000 – 19.990	19 – 25	2.9	•	•	•	•	•

Note: Other Dimension Not Listed above can be ground to your specifications.
 If in doubt please send us your drawing. 'D' tolerance is m5 or +0.005.
 Unless otherwise specified by customer all outside corners will be sharp.

How to order : **CBDH – H – V – P – W – B – L**

Example : **TBDH – H2.000 – V2.000 – P1.500 – W1.500 – B8 – L40**

SOLID CARBIDE BLOCK PUNCHES

- DOUBLE FLANGE, RECTANGLE w/ CORNER RADIUS (**CBDJ**)
- DOUBLE FLANGE, RECTANGLE w/ CORNER RADIUS WITH TiCN COATING (**TBDJ**)

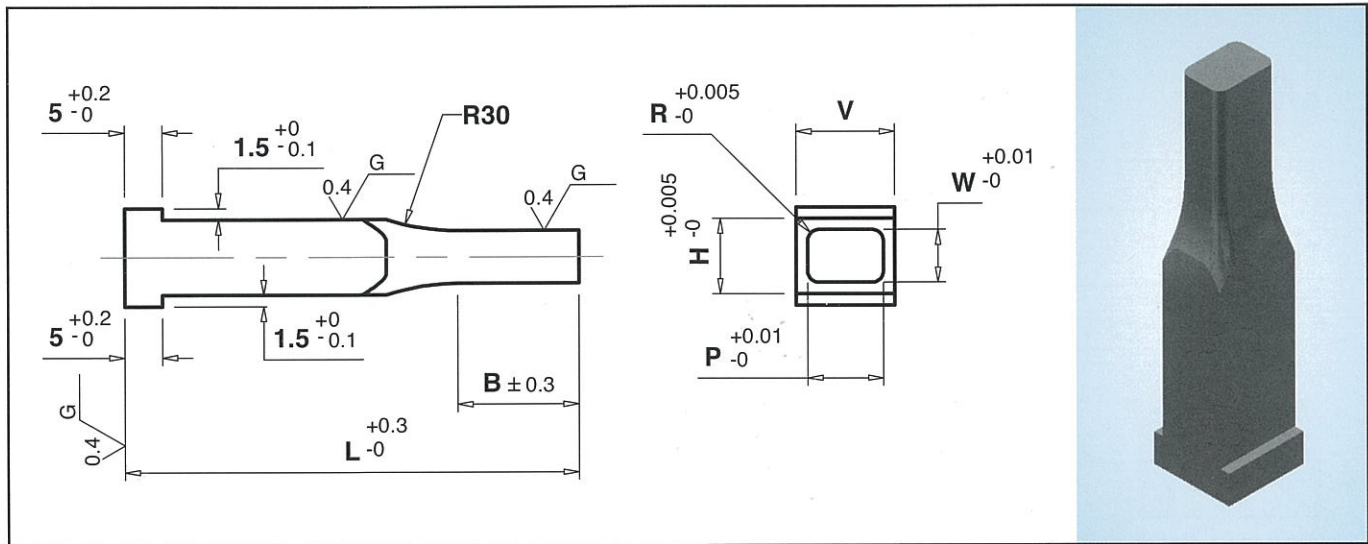

Shank Size		P Point Size		B Point Length	L – Length				
H	V	P	W		40	50	60	70	80
1.500 – 3.990	1.500 – 3.990	1.500 – 2.990	1.500 – 2.990	8 – 13	•	•	•		
2.000 – 4.990	2.000 – 4.990	1.500 – 3.990	1.500 – 3.990	8 – 13	•	•	•	•	
2.000 – 5.990	2.000 – 5.990	1.500 – 4.990	1.500 – 4.990	8 – 13	•	•	•	•	
3.000 – 7.990	3.000 – 7.990	2.000 – 5.990	2.000 – 5.990	13 – 19	•	•	•	•	•
3.000 – 9.990	3.000 – 9.990	3.000 – 7.990	3.000 – 7.990	13 – 19	•	•	•	•	•
6.000 – 12.990	6.000 – 12.990	3.000 – 9.990	3.000 – 9.990	13 – 19	•	•	•	•	•
10.000 – 15.990	10.000 – 15.990	6.000 – 12.990	6.000 – 12.990	19 – 25	•	•	•	•	•
13.000 – 19.990	13.000 – 19.990	10.000 – 15.990	10.000 – 15.990	19 – 25	•	•	•	•	•
18.000 – 24.990	18.000 – 24.990	13.000 – 19.990	13.000 – 19.990	19 – 25	•	•	•	•	•

Note: Other Dimension Not Listed above can be ground to your specifications.
 If in doubt please send us your drawing. 'D' tolerance is m5 or +0.005.
 Unless otherwise specified by customer all outside corners will be sharp.

*** $0.15 \leq R < W/2$

How to order : **CBDJ – H – V – P – W – B – L – R**

Example : **TBDJ – H2.000 – V2.000 – P1.500 – W1.500 – B8 – L40 – R0.15**

SOLID CARBIDE BLOCK PUNCHES

- DOUBLE FLANGE, RECTANGLE w/ CORNER RADIUS WITH AIR HOLE (CBDK)
- DOUBLE FLANGE, RECTANGLE w/ CORNER RADIUS WITH AIR HOLE WITH TiCN COATING (TBDK)

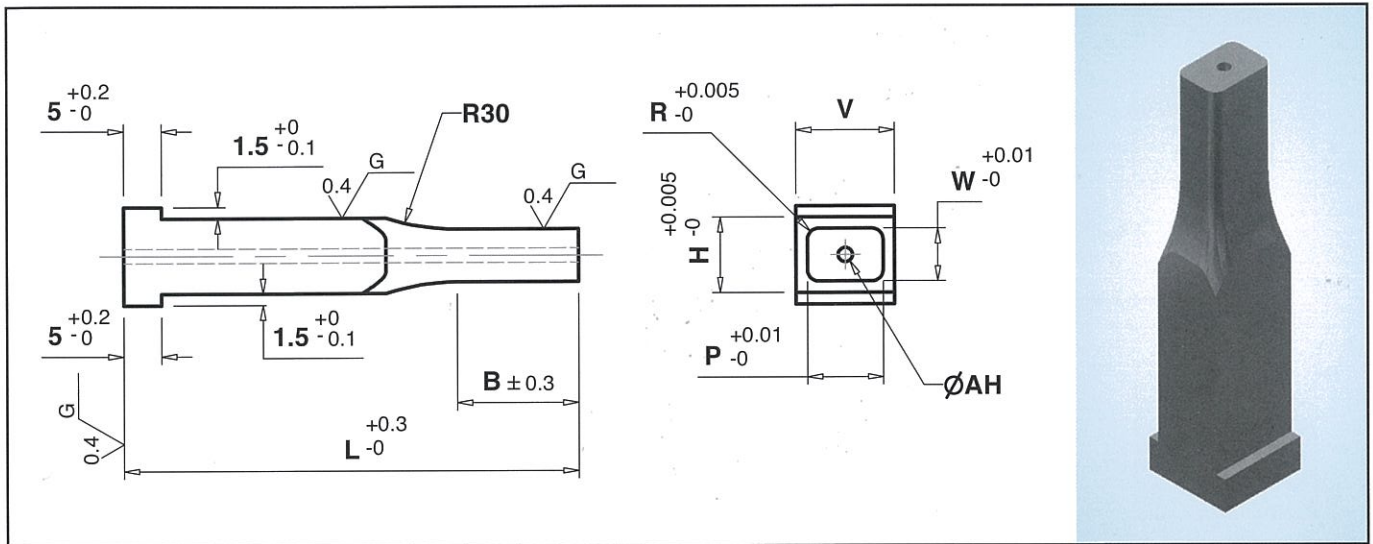

Shank Size		P Point Size		B Point Length	AH Air Hole	L – Length				
H	V	P	W			40	50	60	70	80
1.500 – 3.990	1.500 – 3.990	1.500 – 2.990	1.500 – 2.990	8 – 13	0.5	•	•	•		
2.000 – 4.990	2.000 – 4.990	1.500 – 3.990	1.500 – 3.990	8 – 13	0.8	•	•	•	•	
2.000 – 5.990	2.000 – 5.990	1.500 – 4.990	1.500 – 4.990	8 – 13	0.8	•	•	•	•	
3.000 – 7.990	3.000 – 7.990	2.000 – 5.990	2.000 – 5.990	13 – 19	1.2	•	•	•	•	•
3.000 – 9.990	3.000 – 9.990	3.000 – 7.990	3.000 – 7.990	13 – 19	1.6	•	•	•	•	•
6.000 – 12.990	6.000 – 12.990	3.000 – 9.990	3.000 – 9.990	13 – 19	1.9	•	•	•	•	•
10.000 – 15.990	10.000 – 15.990	6.000 – 12.990	6.000 – 12.990	19 – 25	2.9	•	•	•	•	•
13.000 – 19.990	13.000 – 19.990	10.000 – 15.990	10.000 – 15.990	19 – 25	2.9	•	•	•	•	•
18.000 – 24.990	18.000 – 24.990	13.000 – 19.990	13.000 – 19.990	19 – 25	2.9	•	•	•	•	•

Note: Other Dimension Not Listed above can be ground to your specifications.
 If in doubt please send us your drawing. 'D' tolerance is m5 or +0.005.
 Unless otherwise specified by customer all outside corners will be sharp.

*** $0.15 \leq R < W/2$

How to order : **CBDK – H – V – P – W – B – L – R**

Example : **TBDK – H2.000 – V2.000 – P1.500 – W1.500 – B8 – L40 – R0.15**

SOLID CARBIDE BLOCK PUNCHES

- KEY GROOVE, RECTANGLE (CBEC)
- KEY GROOVE, RECTANGLE WITH TiCN COATING (TBEC)

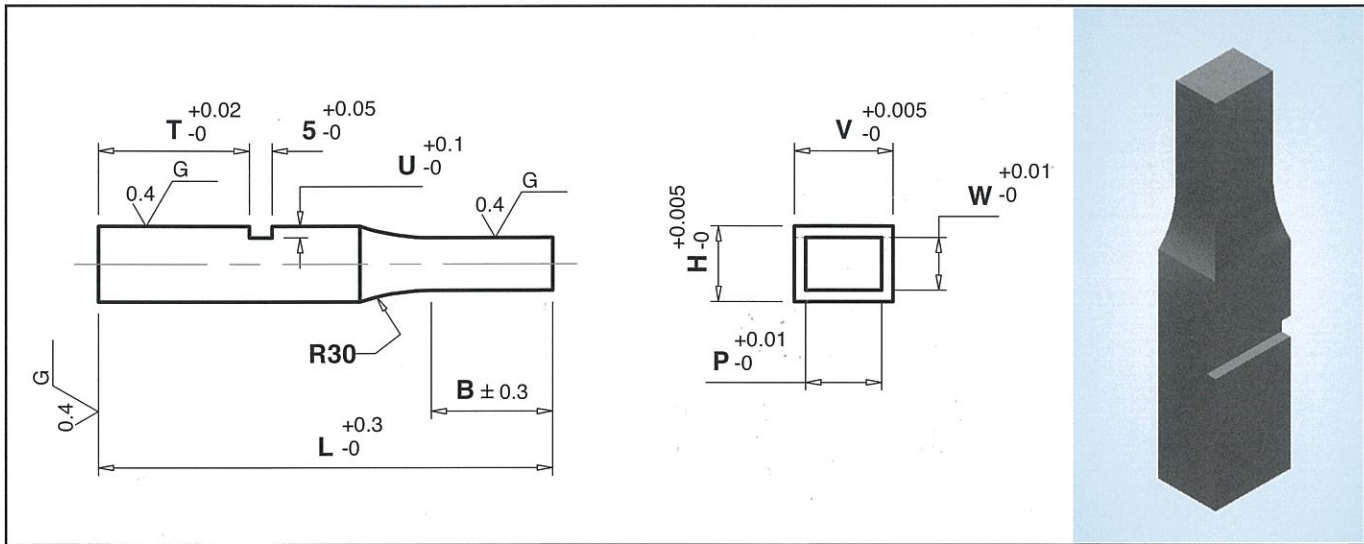

Shank Size		P Point Size		T	U	B	L – Length				
H	V	P	W				40	50	60	70	80
1.500 – 3.990	1.500 – 3.990	1.500 – 2.990	1.500 – 2.990	T ≥ 2.0	1.0	8 – 13	•	•	•		
2.000 – 4.990	2.000 – 4.990	1.500 – 3.990	1.500 – 3.990			8 – 13	•	•	•	•	
2.000 – 5.990	2.000 – 5.990	1.500 – 4.990	1.500 – 4.990			8 – 13	•	•	•	•	
3.000 – 7.990	3.000 – 7.990	2.000 – 5.990	2.000 – 5.990			13 – 19	•	•	•	•	•
3.000 – 9.990	3.000 – 9.990	3.000 – 7.990	3.000 – 7.990		13 – 19	•	•	•	•	•	
6.000 – 12.990	6.000 – 12.990	3.000 – 9.990	3.000 – 9.990		13 – 19	•	•	•	•	•	
10.000 – 15.990	10.000 – 15.990	6.000 – 12.990	6.000 – 12.990		19 – 25	•	•	•	•	•	
13.000 – 19.990	13.000 – 19.990	10.000 – 15.990	10.000 – 15.990		19 – 25	•	•	•	•	•	
18.000 – 24.990	18.000 – 24.990	13.000 – 19.990	13.000 – 19.990		19 – 25	•	•	•	•	•	

Note: Other Dimension Not Listed above can be ground to your specifications.
 If in doubt please send us your drawing. 'D' tolerance is m5 or +0.005.
 Unless otherwise specified by customer all outside corners will be sharp.

How to order : **CBEC – H – V – P – W – T – B – L**
 Example : **TBEC – H2.000 – V2.000 – P1.500 – W1.500 – T2.0 – B8 – L40**

SOLID CARBIDE BLOCK PUNCHES

- KEY GROOVE, RECTANGLE WITH AIR HOLE (**CBED**)
- KEY GROOVE, RECTANGLE WITH AIR HOLE WITH TiCN COATING (**TBED**)

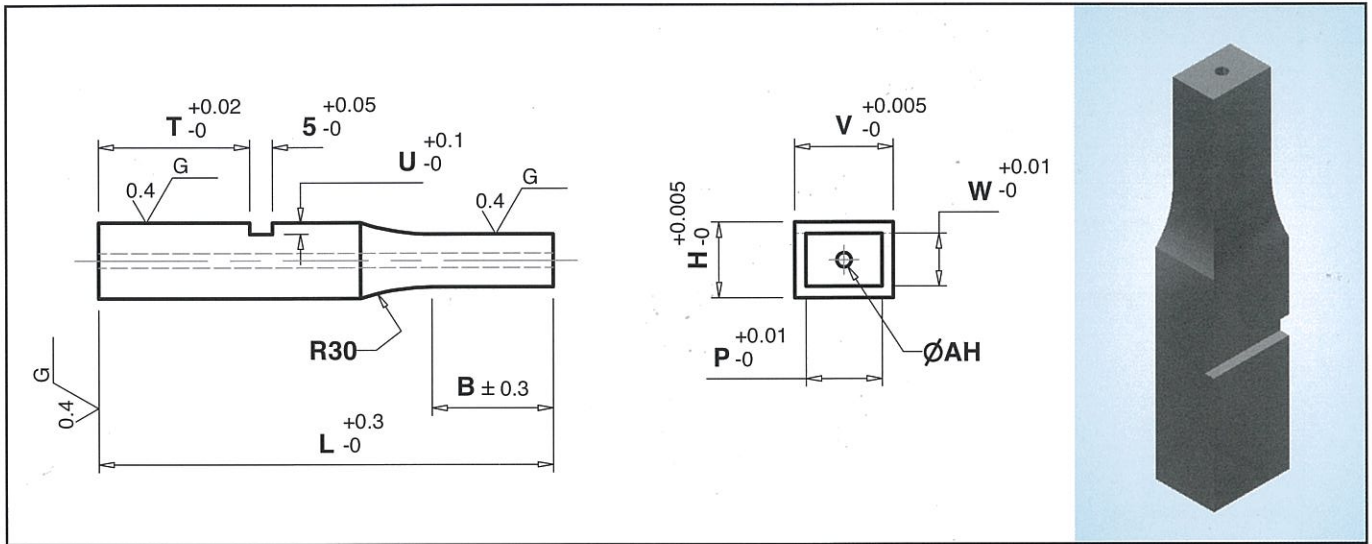

Shank Size		P Point Size		T	U	B	AH	L - Length				
H	V	P	W					40	50	60	70	80
1.500 - 3.990	1.500 - 3.990	1.500 - 2.990	1.500 - 2.990	T ≥ 2.0	1.0	8 - 13	0.5	•	•	•		
2.000 - 4.990	2.000 - 4.990	1.500 - 3.990	1.500 - 3.990			8 - 13	0.8	•	•	•	•	
2.000 - 5.990	2.000 - 5.990	1.500 - 4.990	1.500 - 4.990			8 - 13	0.8	•	•	•	•	
3.000 - 7.990	3.000 - 7.990	2.000 - 5.990	2.000 - 5.990			13 - 19	1.2	•	•	•	•	•
3.000 - 9.990	3.000 - 9.990	3.000 - 7.990	3.000 - 7.990		13 - 19	1.6	•	•	•	•	•	
6.000 - 12.990	6.000 - 12.990	3.000 - 9.990	3.000 - 9.990		13 - 19	1.9	•	•	•	•	•	
10.000 - 15.990	10.000 - 15.990	6.000 - 12.990	6.000 - 12.990		1.5	19 - 25	2.9	•	•	•	•	•
13.000 - 19.990	13.000 - 19.990	10.000 - 15.990	10.000 - 15.990			19 - 25	2.9	•	•	•	•	•
18.000 - 24.990	18.000 - 24.990	13.000 - 19.990	13.000 - 19.990			19 - 25	2.9	•	•	•	•	•
						19 - 25	2.9	•	•	•	•	•

Note: Other Dimension Not Listed above can be ground to your specifications.
 If in doubt please send us your drawing. 'D' tolerance is m5 or +0.005.
 Unless otherwise specified by customer all outside corners will be sharp.

How to order : **CBED - H - V - P - W - T - B - L**

Example : **TBED - H2.000 - V2.000 - P1.500 - W1.500 - T2.0 - B8 - L40**

SOLID CARBIDE BLOCK PUNCHES

- KEY GROOVE, OBLONG (**CBEE**)
- KEY GROOVE, OBLONG WITH TiCN COATING (**TBEE**)

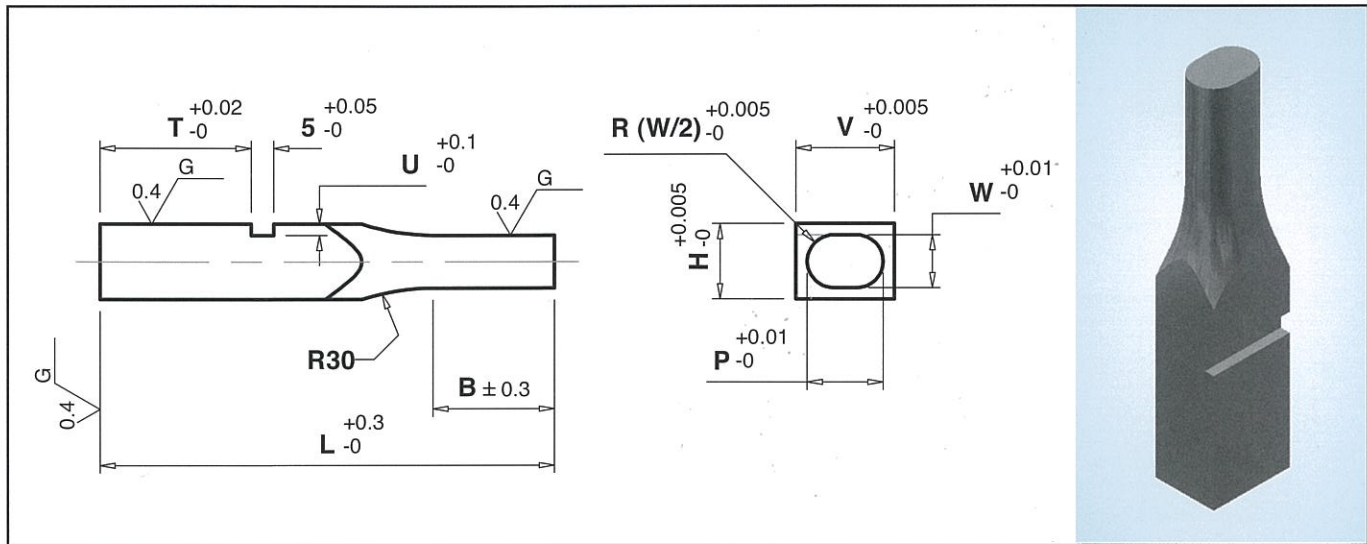

Shank Size		P Point Size		T	U	B	L – Length				
H	V	P	W				40	50	60	70	80
1.500 – 3.990	1.500 – 3.990	1.500 – 2.990	1.500 – 2.990	T ≥ 2.0	1.0	8 – 13	•	•	•		
2.000 – 4.990	2.000 – 4.990	1.500 – 3.990	1.500 – 3.990			8 – 13	•	•	•	•	
2.000 – 5.990	2.000 – 5.990	1.500 – 4.990	1.500 – 4.990			8 – 13	•	•	•	•	
3.000 – 7.990	3.000 – 7.990	2.000 – 5.990	2.000 – 5.990			13 – 19	•	•	•	•	•
3.000 – 9.990	3.000 – 9.990	3.000 – 7.990	3.000 – 7.990		13 – 19	•	•	•	•	•	
6.000 – 12.990	6.000 – 12.990	3.000 – 9.990	3.000 – 9.990		13 – 19	•	•	•	•	•	
10.000 – 15.990	10.000 – 15.990	6.000 – 12.990	6.000 – 12.990		19 – 25	•	•	•	•	•	
13.000 – 19.990	13.000 – 19.990	10.000 – 15.990	10.000 – 15.990		19 – 25	•	•	•	•	•	
18.000 – 24.990	18.000 – 24.990	13.000 – 19.990	13.000 – 19.990		19 – 25	•	•	•	•	•	
						1.5	19 – 25	•	•	•	•

Note: Other Dimension Not Listed above can be ground to your specifications.
 If in doubt please send us your drawing. 'D' tolerance is m5 or +0.005.
 Unless otherwise specified by customer all outside corners will be sharp.

How to order : **CBEE – H – V – P – W – T – B – L**

Example : **TBEE – H2.000 – V2.000 – P1.500 – W1.500 – T2.0 – B8 – L40**

SOLID CARBIDE BLOCK PUNCHES



- KEY GROOVE, OBLONG WITH AIR HOLE (CBEF)
- KEY GROOVE, OBLONG WITH AIR HOLE WITH TiCN COATING (TBEF)

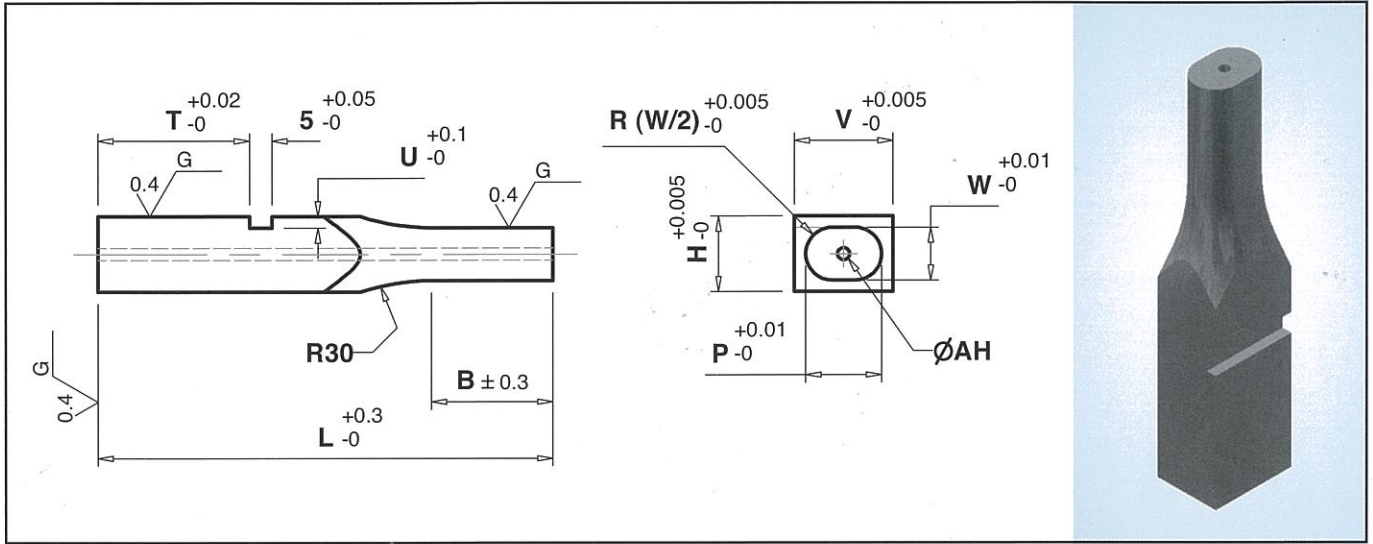

Shank Size		P Point Size		T	U	B	AH	L - Length				
H	V	P	W					40	50	60	70	80
1.500 - 3.990	1.500 - 3.990	1.500 - 2.990	1.500 - 2.990	T ≥ 2.0	1.0	8 - 13	0.5	•	•	•		
2.000 - 4.990	2.000 - 4.990	1.500 - 3.990	1.500 - 3.990			8 - 13	0.8	•	•	•	•	
2.000 - 5.990	2.000 - 5.990	1.500 - 4.990	1.500 - 4.990			8 - 13	0.8	•	•	•	•	
3.000 - 7.990	3.000 - 7.990	2.000 - 5.990	2.000 - 5.990			13 - 19	1.2	•	•	•	•	•
3.000 - 9.990	3.000 - 9.990	3.000 - 7.990	3.000 - 7.990		1.5	13 - 19	1.6	•	•	•	•	•
6.000 - 12.990	6.000 - 12.990	3.000 - 9.990	3.000 - 9.990			13 - 19	1.9	•	•	•	•	•
10.000 - 15.990	10.000 - 15.990	6.000 - 12.990	6.000 - 12.990			19 - 25	2.9	•	•	•	•	•
13.000 - 19.990	13.000 - 19.990	10.000 - 15.990	10.000 - 15.990			19 - 25	2.9	•	•	•	•	•
18.000 - 24.990	18.000 - 24.990	13.000 - 19.990	13.000 - 19.990			19 - 25	2.9	•	•	•	•	•

Note: Other Dimension Not Listed above can be ground to your specifications.
 If in doubt please send us your drawing. 'D' tolerance is m5 or +0.005.
 Unless otherwise specified by customer all outside corners will be sharp.

How to order : CBEF - H - V - P - W - T - B - L

Example : TBEF - H2.000 - V2.000 - P1.500 - W1.500 - T2.0 - B8 - L40

SOLID CARBIDE BLOCK PUNCHES



- KEY GROOVE, FLATTED ROUND (**CBEG**)
- KEY GROOVE, FLATTED ROUND WITH TiCN COATING (**TBEG**)

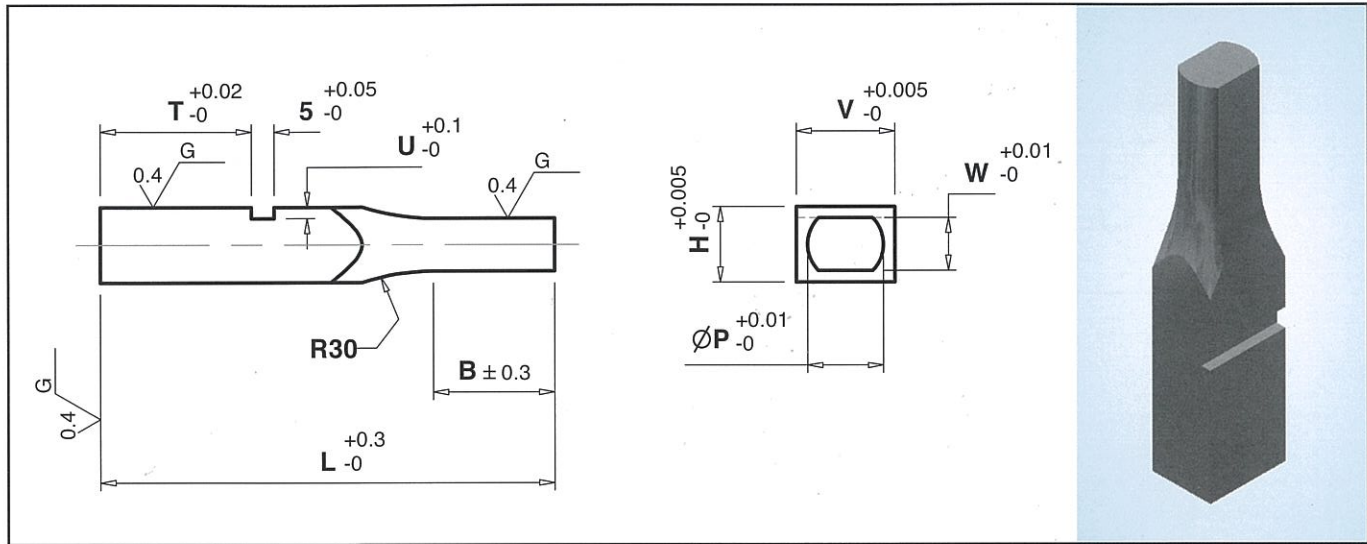

Shank Size		P Point Size		T	U	B	L – Length				
H	V	P	W				40	50	60	70	80
1.500 – 3.990	1.500 – 3.990	1.500 – 2.990	1.500 – 2.990	T ≥ 2.0	1.0	8 – 13	•	•	•		
2.000 – 4.990	2.000 – 4.990	1.500 – 3.990	1.500 – 3.990			8 – 13	•	•	•	•	
2.000 – 5.990	2.000 – 5.990	1.500 – 4.990	1.500 – 4.990			8 – 13	•	•	•	•	
3.000 – 7.990	3.000 – 7.990	2.000 – 5.990	2.000 – 5.990			13 – 19	•	•	•	•	•
3.000 – 9.990	3.000 – 9.990	3.000 – 7.990	3.000 – 7.990		1.5	13 – 19	•	•	•	•	•
6.000 – 12.990	6.000 – 12.990	3.000 – 9.990	3.000 – 9.990			13 – 19	•	•	•	•	•
10.000 – 15.990	10.000 – 15.990	6.000 – 12.990	6.000 – 12.990			19 – 25	•	•	•	•	•
13.000 – 19.990	13.000 – 19.990	10.000 – 15.990	10.000 – 15.990			19 – 25	•	•	•	•	•
18.000 – 24.990	18.000 – 24.990	13.000 – 19.990	13.000 – 19.990			19 – 25	•	•	•	•	•

Note: Other Dimension Not Listed above can be ground to your specifications.
 If in doubt please send us your drawing. 'D' tolerance is m5 or +0.005.
 Unless otherwise specified by customer all outside corners will be sharp.

How to order : **CBEG – H – V – P – W – T – B – L**

Example : **TBEG – H2.000 – V2.000 – P1.500 – W1.500 – T2.0 – B8 – L40**

SOLID CARBIDE BLOCK PUNCHES

- KEY GROOVE, FLATTED ROUND WITH AIR HOLE (**CBEH**)
- KEY GROOVE, FLATTED ROUND WITH AIR HOLE WITH TiCN COATING (**TBEH**)

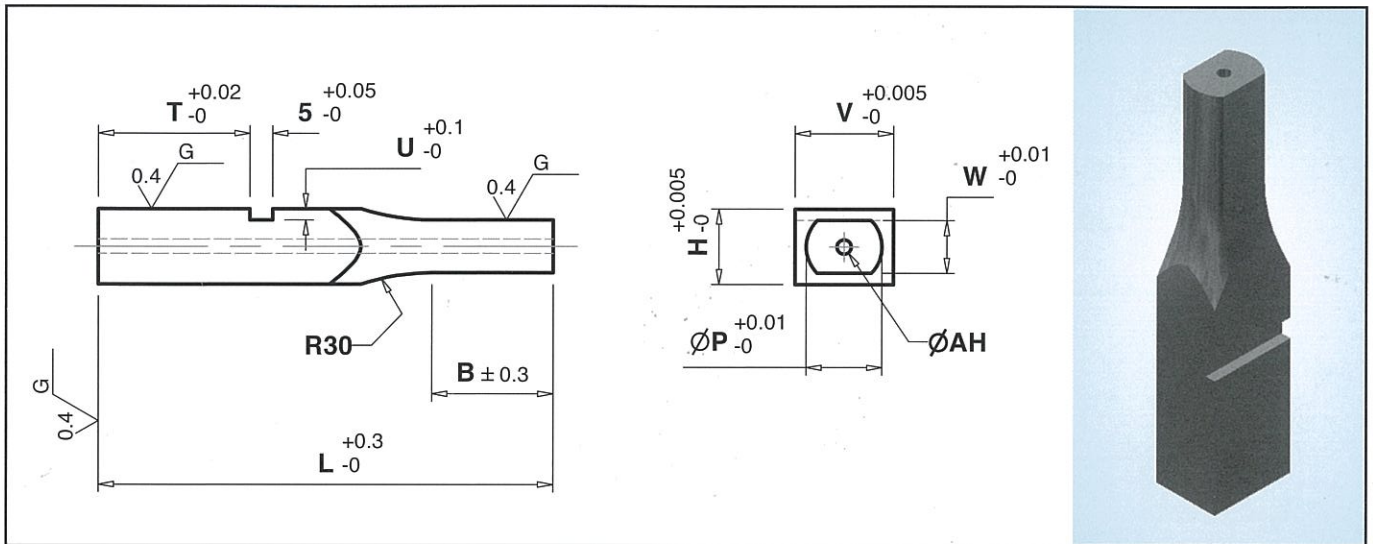

Shank Size		P Point Size		T	U	B	AH	L - Length				
H	V	P	W					40	50	60	70	80
1.500 - 3.990	1.500 - 3.990	1.500 - 2.990	1.500 - 2.990	T ≥ 2.0	1.0	8 - 13	0.5	•	•	•		
2.000 - 4.990	2.000 - 4.990	1.500 - 3.990	1.500 - 3.990			8 - 13	0.8	•	•	•	•	
2.000 - 5.990	2.000 - 5.990	1.500 - 4.990	1.500 - 4.990			8 - 13	0.8	•	•	•	•	
3.000 - 7.990	3.000 - 7.990	2.000 - 5.990	2.000 - 5.990			13 - 19	1.2	•	•	•	•	•
3.000 - 9.990	3.000 - 9.990	3.000 - 7.990	3.000 - 7.990		1.5	13 - 19	1.6	•	•	•	•	•
6.000 - 12.990	6.000 - 12.990	3.000 - 9.990	3.000 - 9.990			13 - 19	1.9	•	•	•	•	•
10.000 - 15.990	10.000 - 15.990	6.000 - 12.990	6.000 - 12.990			19 - 25	2.9	•	•	•	•	•
13.000 - 19.990	13.000 - 19.990	10.000 - 15.990	10.000 - 15.990			19 - 25	2.9	•	•	•	•	•
18.000 - 24.990	18.000 - 24.990	13.000 - 19.990	13.000 - 19.990			19 - 25	2.9	•	•	•	•	•

Note: Other Dimension Not Listed above can be ground to your specifications.
 If in doubt please send us your drawing. 'D' tolerance is m5 or +0.005.
 Unless otherwise specified by customer all outside corners will be sharp.

How to order : **CBEH - H - V - P - W - T - B - L**

Example : **TBEH - H2.000 - V2.000 - P1.500 - W1.500 - T2.0 - B8 - L40**

SOLID CARBIDE BLOCK PUNCHES

- KEY GROOVE, RECTANGLE w/ CORNER RADIUS (**CBEJ**)
- KEY GROOVE, RECTANGLE w/ CORNER RADIUS WITH TiCN COATING (**TBEJ**)

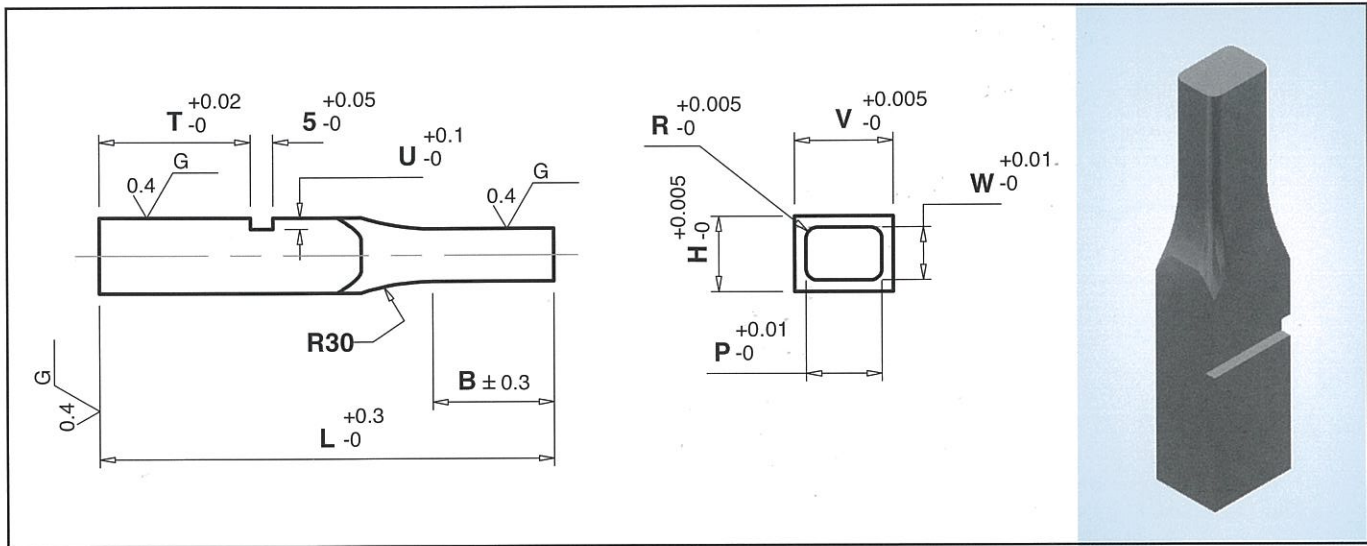

Shank Size		P Point Size		T	U	B	L – Length				
H	V	P	W				40	50	60	70	80
1.500 – 3.990	1.500 – 3.990	1.500 – 2.990	1.500 – 2.990	T ≥ 2.0	1.0	8 – 13	•	•	•		
2.000 – 4.990	2.000 – 4.990	1.500 – 3.990	1.500 – 3.990			8 – 13	•	•	•	•	
2.000 – 5.990	2.000 – 5.990	1.500 – 4.990	1.500 – 4.990			8 – 13	•	•	•	•	
3.000 – 7.990	3.000 – 7.990	2.000 – 5.990	2.000 – 5.990			13 – 19	•	•	•	•	•
3.000 – 9.990	3.000 – 9.990	3.000 – 7.990	3.000 – 7.990			13 – 19	•	•	•	•	•
6.000 – 12.990	6.000 – 12.990	3.000 – 9.990	3.000 – 9.990		1.5	13 – 19	•	•	•	•	•
10.000 – 15.990	10.000 – 15.990	6.000 – 12.990	6.000 – 12.990			19 – 25	•	•	•	•	•
13.000 – 19.990	13.000 – 19.990	10.000 – 15.990	10.000 – 15.990			19 – 25	•	•	•	•	•
18.000 – 24.990	18.000 – 24.990	13.000 – 19.990	13.000 – 19.990			19 – 25	•	•	•	•	•
						19 – 25	•	•	•	•	•

Note: Other Dimension Not Listed above can be ground to your specifications.
 If in doubt please send us your drawing. 'D' tolerance is m5 or +0.005.
 Unless otherwise specified by customer all outside corners will be sharp.

***0.15 ≤ R < W/2

How to order : **CBEJ – H – V – P – W – T – B – L – R**

Example : **TBEJ – H2.000 – V2.000 – P1.500 – W1.500 – T2.0 – B8 – L40 – R0.15**

SOLID CARBIDE BLOCK PUNCHES



- KEY GROOVE, RECTANGLE w/ CORNER RADIUS WITH AIR HOLE (CBEK)
- KEY GROOVE, RECTANGLE w/ CORNER RADIUS WITH AIR HOLE & TiCN COATING (TBEK)

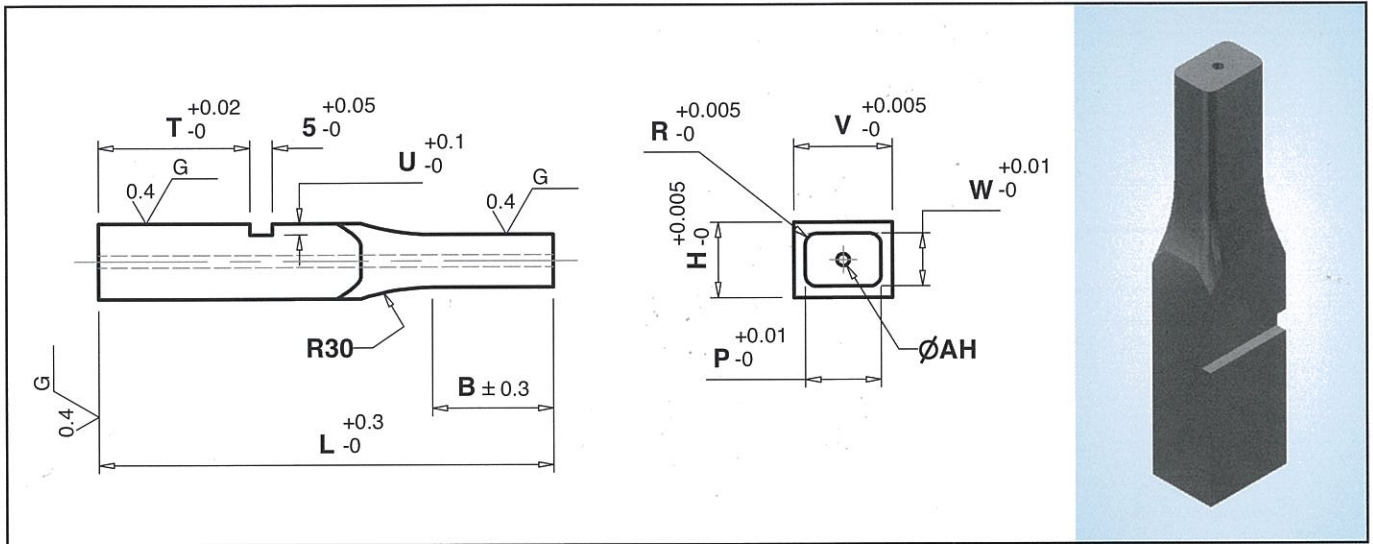

Shank Size		P Point Size		T	U	B	AH	L - Length				
H	V	P	W					40	50	60	70	80
1.500 - 3.990	1.500 - 3.990	1.500 - 2.990	1.500 - 2.990	T ≥ 2.0	1.0	8 - 13	0.5	•	•	•		
2.000 - 4.990	2.000 - 4.990	1.500 - 3.990	1.500 - 3.990			8 - 13	0.8	•	•	•	•	
2.000 - 5.990	2.000 - 5.990	1.500 - 4.990	1.500 - 4.990			8 - 13	0.8	•	•	•	•	
3.000 - 7.990	3.000 - 7.990	2.000 - 5.990	2.000 - 5.990			13 - 19	1.2	•	•	•	•	•
3.000 - 9.990	3.000 - 9.990	3.000 - 7.990	3.000 - 7.990		1.5	13 - 19	1.6	•	•	•	•	•
6.000 - 12.990	6.000 - 12.990	3.000 - 9.990	3.000 - 9.990			13 - 19	1.9	•	•	•	•	•
10.000 - 15.990	10.000 - 15.990	6.000 - 12.990	6.000 - 12.990			19 - 25	2.9	•	•	•	•	•
13.000 - 19.990	13.000 - 19.990	10.000 - 15.990	10.000 - 15.990			19 - 25	2.9	•	•	•	•	•
18.000 - 24.990	18.000 - 24.990	13.000 - 19.990	13.000 - 19.990			19 - 25	2.9	•	•	•	•	•

Note: Other Dimension Not Listed above can be ground to your specifications.
 If in doubt please send us your drawing. 'D' tolerance is m5 or +0.005.
 Unless otherwise specified by customer all outside corners will be sharp.

***0.15 ≤ R < W/2

How to order : **CBEK - H - V - P - W - T - B - L - R**

Example : **TBEK - H2.000 - V2.000 - P1.500 - W1.500 - T2.0 - B8 - L40 - R0.15**

SOLID CARBIDE BLOCK PUNCHES

- STRAIGHT STANDARD, RECTANGLE (**CBFC**)
- STRAIGHT STANDARD, OBLONG (**CBFE**)
- STRAIGHT STANDARD, RECTANGLE w/ CORNER RADIUS (**CBFJ**)
- STRAIGHT STANDARD, FLATTED ROUND (**CBFG**)

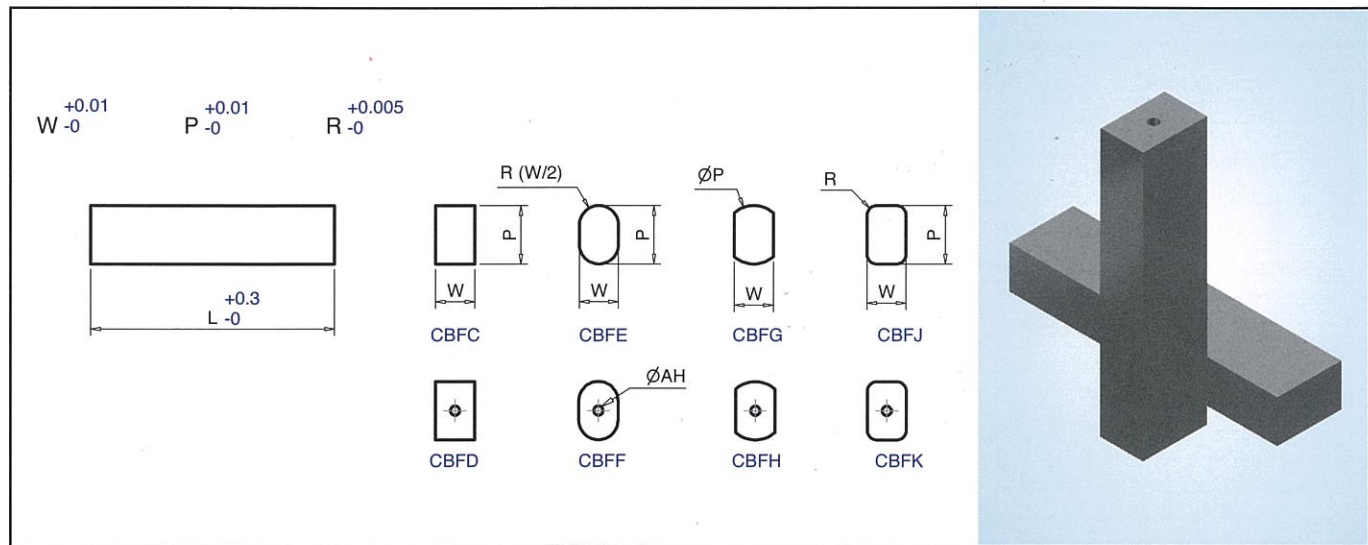

W	P	AH	L
2.00 – 3.00	2.00 – 16.00	0.8	40.0 – 80.0
3.01 – 4.00	2.00 – 16.00	0.8	
4.01 – 5.00	2.00 – 16.00	0.8	
5.01 – 6.00	5.00 – 16.00	0.8	
6.01 – 8.00	5.00 – 16.00	1.2	
8.01 – 10.00	5.00 – 16.00	1.6	
10.01 – 16.00	10.00 – 16.00	1.9	

*** $0.15 \leq R < W/2$

Note: Other Dimension Not Listed above can be ground to your specifications.
 If in doubt please send us your drawing. 'D' tolerance is m5 or +0.005.
 Unless otherwise specified by customer all outside corners will be sharp.

How to order : **CBFC – W – P – L**
 Example : **CBFG – W3.00 – P2.00 – L40.0**

SOLID CARBIDE BLOCK PUNCHES

- STRAIGHT TAPPED, RECTANGLE (CBGC)
- STRAIGHT TAPPED, OBLONG (CBGE)
- STRAIGHT TAPPED, RECTANGLE w/ CORNER RADIUS (CBGJ)
- STRAIGHT TAPPED, FLATTED ROUND (CBGG)

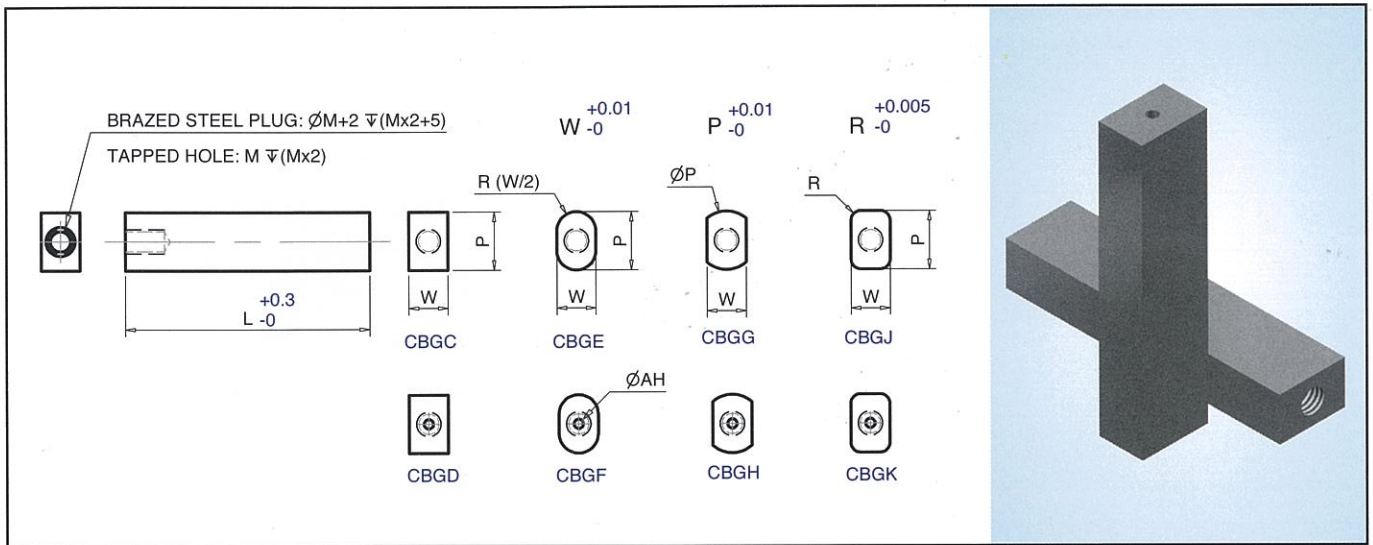

W	P	M	AH	L
12.00 – 13.00	12.00 – 20.00	8	1.9	40 – 70
13.00 – 16.00	12.00 – 20.00		1.9	
16.00 – 20.00	16.00 – 20.00		1.9	

*** $0.15 \leq R < W/2$

Note: Other Dimension Not Listed above can be ground to your specifications.
If in doubt please send us your drawing. 'D' tolerance is m5 or +0.005.
Unless otherwise specified by customer all outside corners will be sharp.

How to order : **CBGC – W – P – L**

Example : **CBGG – W12.00 – P12.00 – L40.0**

SOLID CARBIDE BLOCK PUNCHES

- STRAIGHT SINGLE FLANGE, RECTANGLE (CBHC)
- STRAIGHT SINGLE FLANGE, OBLONG (CBHE)
- STRAIGHT SINGLE FLANGE, RECTANGLE w/ CORNER RADIUS (CBHJ)
- STRAIGHT SINGLE FLANGE, FLATTED ROUND (CBHG)

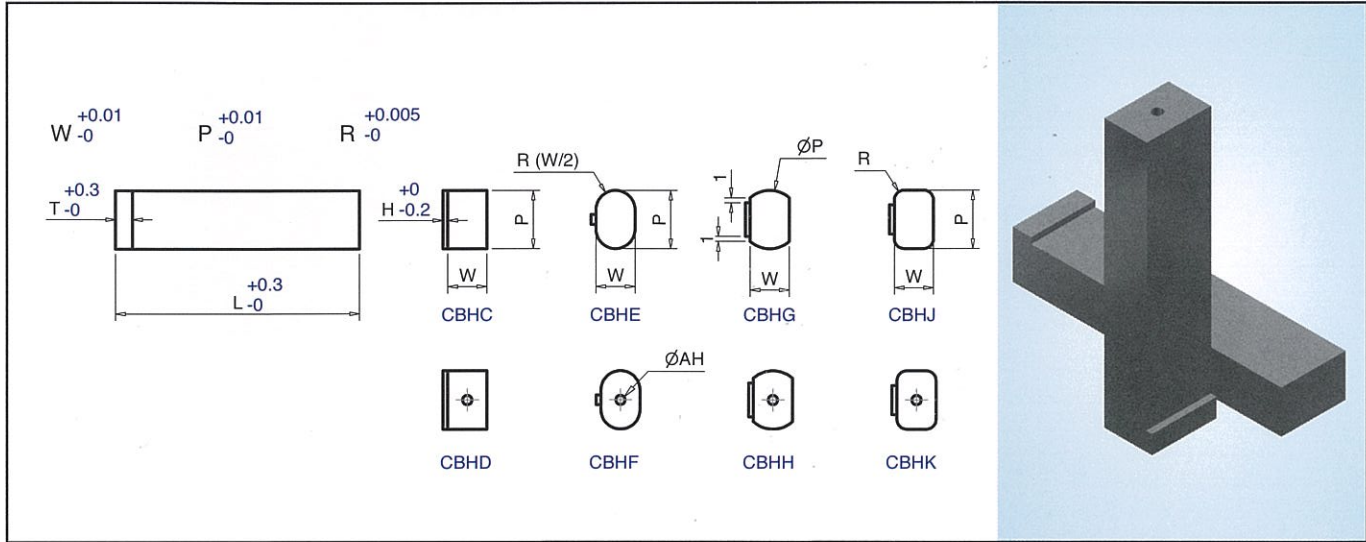

W	P	T	H	AH	L
2.00 – 3.00	2.00 – 16.00	5	1.5	0.8	40.0 – 80.0
3.01 – 4.00	2.00 – 16.00			0.8	
4.01 – 5.00	2.00 – 16.00			0.8	
5.01 – 6.00	5.00 – 16.00			0.8	
6.01 – 8.00	5.00 – 16.00			1.2	
8.01 – 10.00	5.00 – 16.00			1.6	
10.01 – 16.00	10.00 – 16.00			1.9	

*** $0.15 \leq R < W/2$

Note: Other Dimension Not Listed above can be ground to your specifications.
 If in doubt please send us your drawing. 'D' tolerance is m5 or +0.005.
 Unless otherwise specified by customer all outside corners will be sharp.

How to order : **CBHC – W – P – L**
 Example : **CBHG – W3.00 – P2.00 – L40.0**

SOLID CARBIDE BLOCK PUNCHES

- STRAIGHT DOUBLE FLANGE, RECTANGLAR (**CBJC**)
- STRAIGHT DOUBLE FLANGE, OBLONG (**CBJE**)
- STRAIGHT DOUBLE FLANGE, RECTANGLE w/ CORNER RADIUS (**CBJJ**)
- STRAIGHT DOUBLE FLANGE, FLATTED ROUND (**CBJG**)

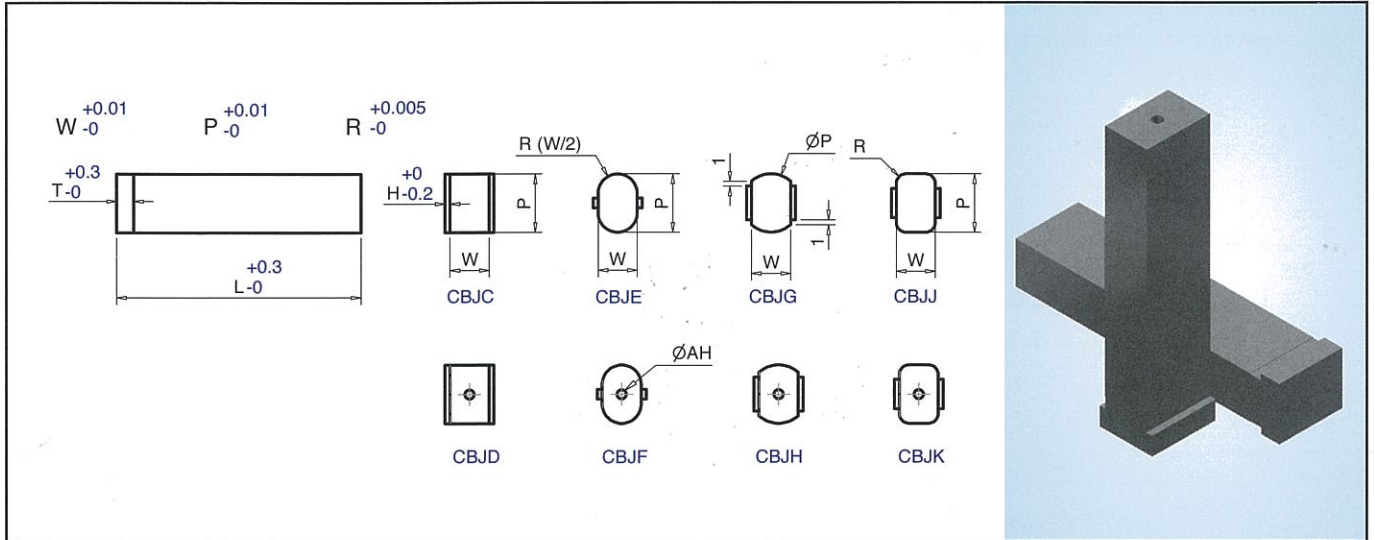

W	P	T	H	AH	L
2.00 – 3.00	2.00 – 16.00	5	1.5	0.8	40.0 – 80.0
3.01 – 4.00	2.00 – 16.00			0.8	
4.01 – 5.00	2.00 – 16.00			0.8	
5.01 – 6.00	5.00 – 16.00			0.8	
6.01 – 8.00	5.00 – 16.00			1.2	
8.01 – 10.00	5.00 – 16.00			1.6	
10.01 – 16.00	10.00 – 16.00			1.9	

*** $0.15 \leq R < W/2$

Note: Other Dimension Not Listed above can be ground to your specifications.
 If in doubt please send us your drawing. 'D' tolerance is m5 or +0.005.
 Unless otherwise specified by customer all outside corners will be sharp.

How to order : **CBJC – W – P – L**
 Example : **CBJG – W3.00 – P2.00 – L40.0**

SOLID CARBIDE BLOCK PUNCHES

- STRAIGHT KEY GROOVE, RECTANGLE (**CBKC**)
- STRAIGHT KEY GROOVE, OBLONG (**CBKE**)
- STRAIGHT KEY GROOVE, RECTANGLE w/ CORNER RADIUS (**CBKJ**)
- STRAIGHT KEY GROOVE, FLATTED ROUND (**CBKG**)

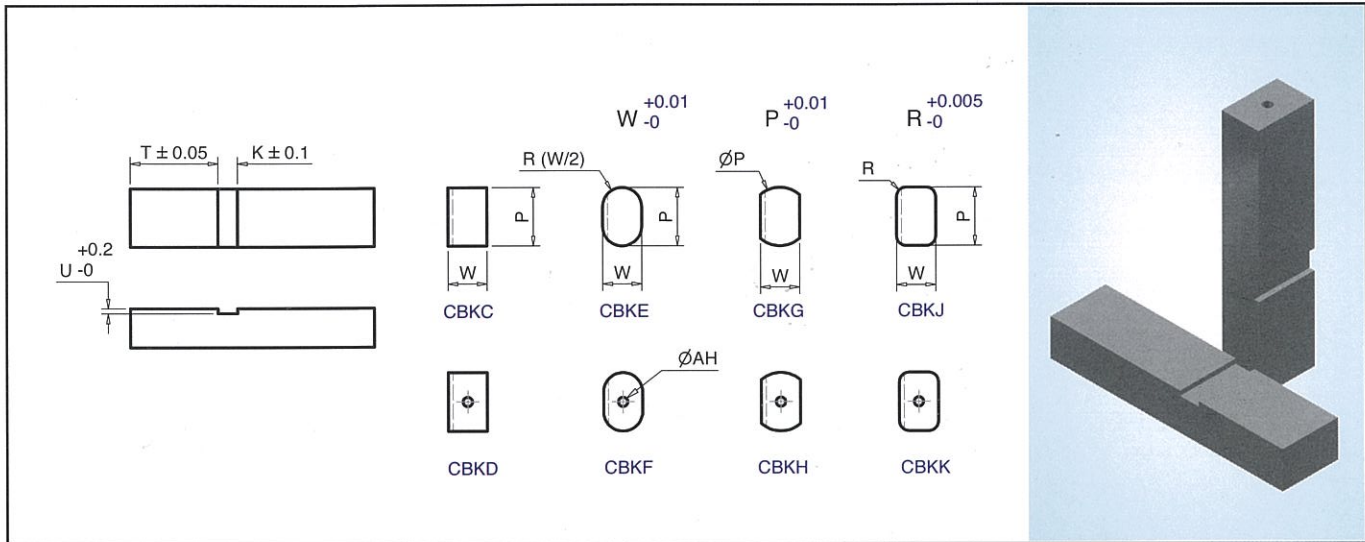

W	P	T	U	AH	L
2.00 – 3.00	2.00 – 16.00	T ≥ 2	1.0	0.8	40.0 – 80.0
3.01 – 4.00	2.00 – 16.00			0.8	
4.01 – 5.00	2.00 – 16.00			0.8	
5.01 – 6.00	5.00 – 16.00			0.8	
6.01 – 8.00	5.00 – 16.00		1.5	1.2	
8.01 – 10.00	5.00 – 16.00		1.6		
10.01 – 16.00	10.00 – 16.00		1.9		

*** $0.15 \leq R < W/2$

Note: Other Dimension Not Listed above can be ground to your specifications.
 If in doubt please send us your drawing. 'D' tolerance is m5 or +0.005.
 Unless otherwise specified by customer all outside corners will be sharp.

How to order : **CBKC – W – P – T – L**
 Example : **CBKG – W3.00 – P2.00 – T2.0 – L40.0**